

Product End-of-Life Instructions

Product Range: LC1F (330 to 1250A) Coriolis

Marketing Model/Name:

**The End of Life Instruction (EOLI) covers the following generic references in the F range
Tesy LC1F-330 to LC1F-1250.**

Purpose:

The product family must be disposed according to the legislation of the country. This document is intended for use by end of life recyclers or treatment facilities. It provides the basic information to assure an appropriate end of life treatment for the components and materials of the product.

Note :

This product family is in the scope of EU directive 2002/96/EC, Waste Electrical and Electronic Equipment (WEEE).



Size in mm

H x L x D in mm: 264 x 309 x 255 for a 3-pole
264 x 389 x 255 for a 4-pole

Weight in kg : 18.6 kg

Operations recommended for the end of life treatment

There are several steps to process the products at the end of life so as to recover components, materials or energy :
Reuse → Depollution → Dismantling → Shredding.

The components of the products that optimize the recycling performances are listed, identified and located hereunder.

This product contains a printed circuit board which is recommended to be treated separately during the end of Life operations.

LC1F630 series contain springs which can be charged of energy. Be careful of these components ejection when operating.

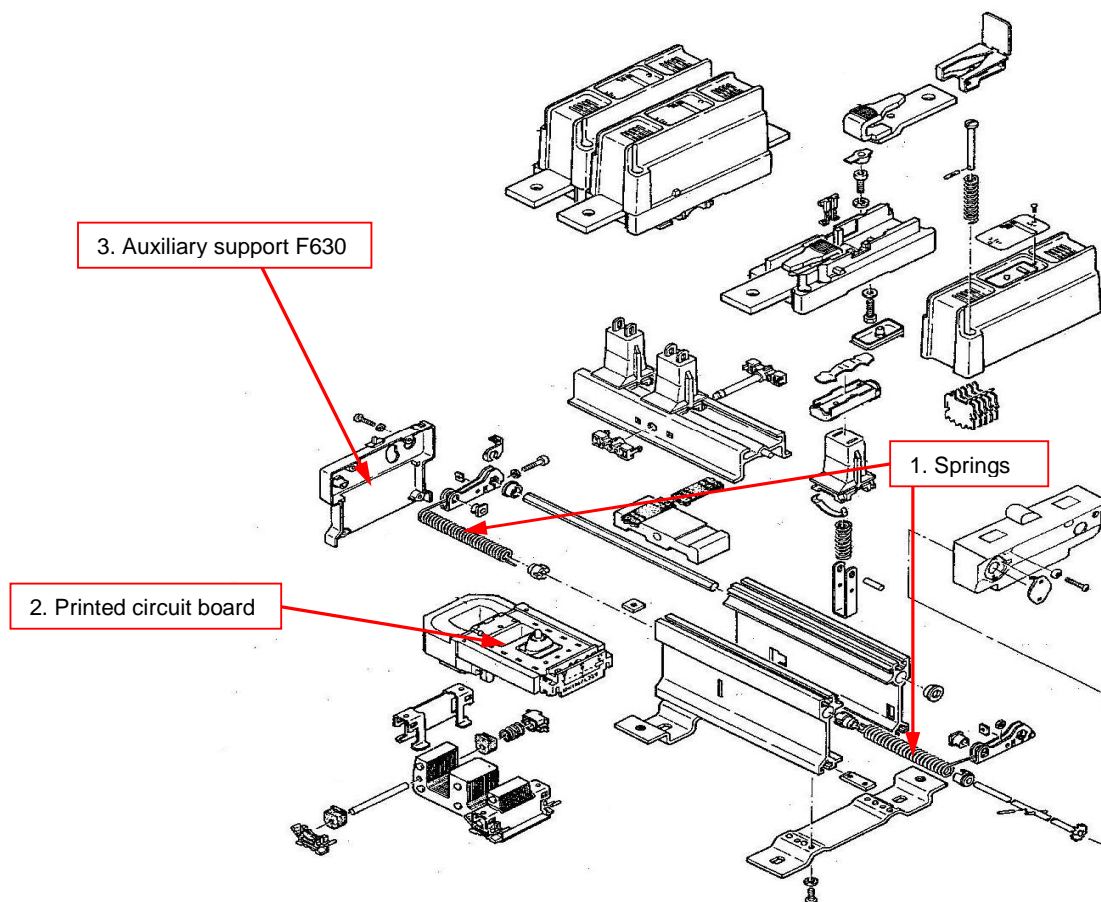

Number on drawing	Components	Weight (g)	Comment
Components listed for operating hazards			
1	Springs		
Components listed for special treatment			
2	Printed circuit board	70 g	Break the bobbin's plastic to extract the PCB
3	Auxiliary support F630	92.5 g	Contains brominated flame retardant

Schneider Electric SA
43-45, boulevard Franklin Roosevelt
F-92500 Rueil-Malmaison Cedex (France)
Tel.: +33 (0) 1 41 29 70 00
www.schneider-electric.com

The version of the Guide used to create the document: End of Life
Instruction Drafting Guide of Schneider Electric version V2

ENVEOL101214EN

Publication date : 06/12/2018