

## DPA CL8 EA 4PPOE (929 161)

- Ideal for protecting Ethernet applications up to 10 GBit/s
- For use in structured cabling systems according to class E<sub>A</sub> up to 500 MHz
- Power over Ethernet IEEE 802.3 compliant (up to PoE++ / 4PPoE)
- For installation in conformity with the lightning protection zone concept at the boundaries from 0<sub>A</sub> -2 and higher

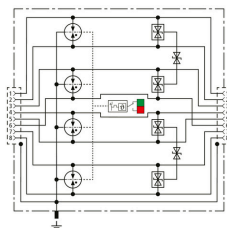

Figure without obligation



Basic circuit diagram DPA CL8 EA 4PPOE

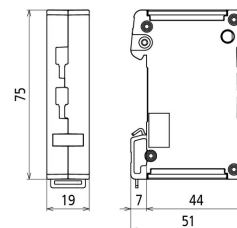

Dimension drawing DPA CL8 EA 4PPOE

Universal, space-saving combined arrester of 19 mm in width and RJ45 connection system with status indication for simple maintenance. Protection of applications in structured cabling according to class E<sub>A</sub> to 500 MHz; e.g. industrial Ethernet, data distributors, digital camera systems, Power over Ethernet (IEEE 802.3 compliant to 4PPoE) and Ethernet-based interfaces in general. Protection of all pairs through powerful gas discharge tubes and protective diodes between signal cores and pairs. Fully shielded adapter design with RJ45 sockets for DIN rail mounting. With additional screw connection on the enclosure for an optional earth connection.

Type	DPA CL8 EA 4PPOE
Part No.	929 161
SPD class	TYPE 1 P2
Impulse category	D1, C1, C2, C3
Nominal voltage (U <sub>N</sub> )	3.3 V
Max. continuous operating voltage (d.c.) (U <sub>c</sub> )	3.3 V
Max. continuous operating voltage (d.c.) pair-pair (PoE) (U <sub>c</sub> )	58 V
Nominal current (I <sub>N</sub> )	1.5 A
D1 Lightning impulse current (10/350 μs) per line (I <sub>imp</sub> )	0.5 kA
C2 Nominal discharge current (8/20 μs) line-line (I <sub>n</sub> )	150 A
C2 Nominal discharge current (8/20 μs) line-PG (I <sub>n</sub> )	2.5 kA
C2 Total nominal discharge current (8/20 μs) (I <sub>n</sub> )	10 kA
C2 Nominal discharge current (8/20 μs) pair-pair (PoE) (I <sub>n</sub> )	150 A
Voltage protection level line-line for I <sub>n</sub> C2 (U <sub>p</sub> )	≤ 100 V
Voltage protection level line-PG for I <sub>n</sub> C2 (U <sub>p</sub> )	≤ 600 V
Voltage protection level line-line for I <sub>n</sub> C2 (PoE) (U <sub>p</sub> )	≤ 100 V
Voltage protection level line-line at 1 kV/μs C3 (U <sub>p</sub> )	≤ 140 V
Voltage protection level line-PG at 1 kV/μs C3 (U <sub>p</sub> )	≤ 500 V
Voltage protection level pair-pair at 1 kV/μs C3 (PoE) (U <sub>p</sub> )	≤ 170 V
Cut-off frequency (f <sub>c</sub> )	500 MHz
Capacitance line-line (C)	≤ 15 pF
Capacitance line-PG (C)	≤ 40 pF
Operating temperature range (T <sub>U</sub> )	-40°C to +80°C
Degree of protection	IP 20
For mounting on	35 mm DIN rails acc. to EN 60715
Connection (input / output)	RJ45 socket / RJ45 socket
Pinning	1/2, 3/6, 4/5, 7/8
Earthing via	35 mm DIN rail acc. to EN 60715
Enclosure material	zinc die casting
Colour	bare surface
Test standards	IEC 61643-21 / EN 61643-21
Approvals	GHMT
Weight	180 g
Customs tariff number	85363010
GTIN	4013364472921
PU	1 Stk

We reserve the right to introduce changes in performance, configuration and technology, dimensions, weights and materials in the course of technical progress. The figures are shown without obligation.