

Product End-of-Life Instructions

Momentum Unity CPU

Product Range

Momentum Unity CPU

Marketing Model

171CBU78090, 171CBU98090, 171CBU98091

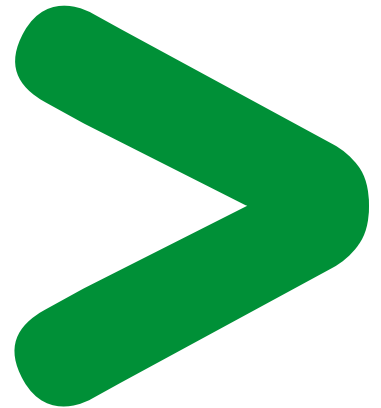
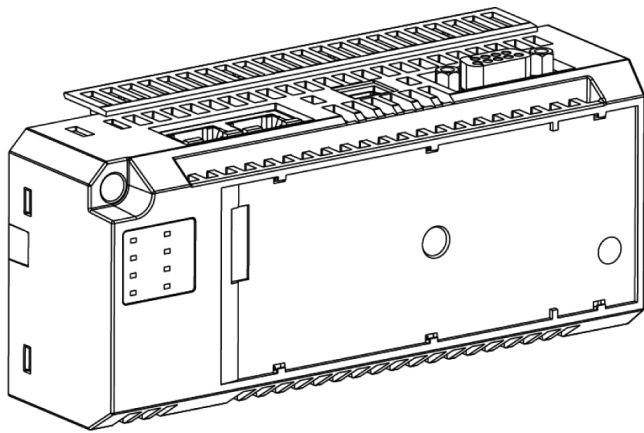

Size in mm :

H x L x D : 70 x 204 x 108

Weight in g (excluding packaging) :

Between 157 and 168 without battery



Operations recommended for the end of life treatment

There are several steps to process the products at the end of life so as to recover components, materials or energy :

Reuse ⇒ **Separation for special treatment** ⇒ **Other dismantling** ⇒ **Shredding**

The components of the products that optimize the recycling performances are listed, identified and located hereunder.

This product contains printed circuit boards and battery which are recommended to be treated separately during the End of Life operations.

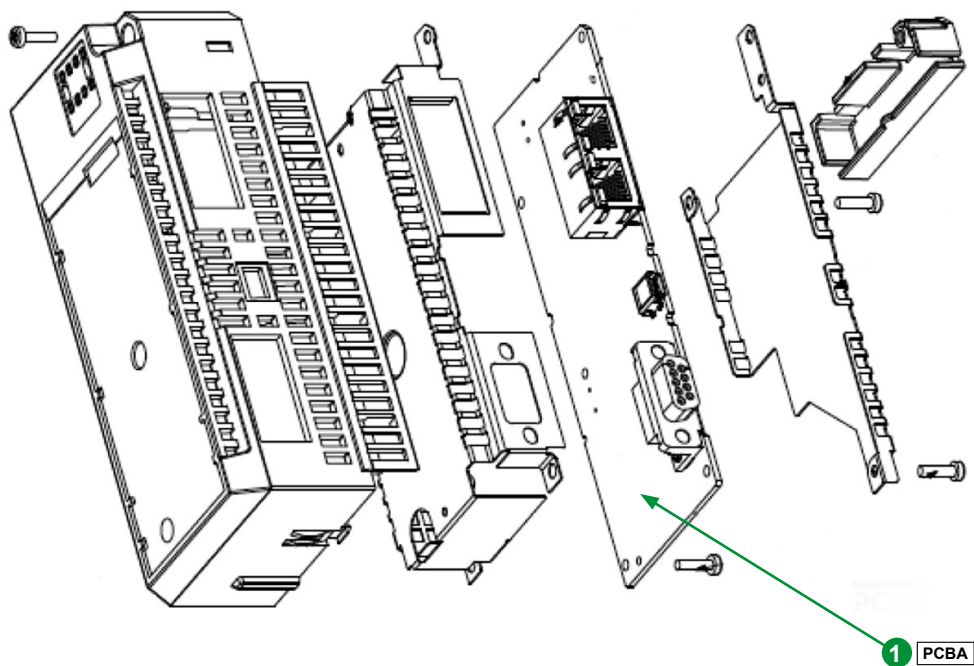

Recommendation	Number on drawing	Components	Weight (g)	Comments
Special treatment	1	PCBA	51.5	-

Schneider Electric Industries SAS

35, rue Joseph Monier
CS30323
F - 92506 Rueil Malmaison Cedex

RCS Nanterre 954 503 439
Capital social 896 313 776 €
www.schneider-electric.com

The version of the Guide used to create the document: End of Life Instruction Drafting Guide of Schneider Electric version V3.

Publication : Schneider Electric