

### TECHNISCHE DATEN:

#### Aufbau

Verschlussstopfen Polyamid PA6 (M12 - M32)  
Polyacetal POM (M40 - M63)

#### Eigenschaften

- Verwendung nur in Ex-Kabelverschraubungen folgender Serien:  
GHG9601955R00zz, GHG9601955R01zz, GHG9601955R005z, GHG9601956R00zz
- zum sicheren Verschließen von Ex-Kabelverschraubungen, in die keine Kabel oder Leitungen installiert sind

Gruppe (Zone) II 2 G (1,2) II 2 D (21,22)  
Kennzeichnung Ex e IIC Gb Ex tb IIIC Db  
Temperaturbereich -55 °C / +70 °C  
Schutzart IP66 (bei fachgerechter Montage, siehe Betriebsanleitung)  
Prüfnorm EN IEC 60079-0:2018, IEC 60079-0:2017  
EN IEC 60079-7:2015+A1, IEC 60079-7:2015+A1  
EN 60079-31:2014, IEC 60079-31:2013  
EG-Prüfbescheinigung PTB 14 ATEX 1015 X  
IECEX-Zertifikat IECEX PTB 14.0027X

### TECHNICAL DATA:

#### Configuration

Blanking plug Polyamide PA6 (M12 - M32)  
Polyacetal POM (M40 - M63)

#### Properties

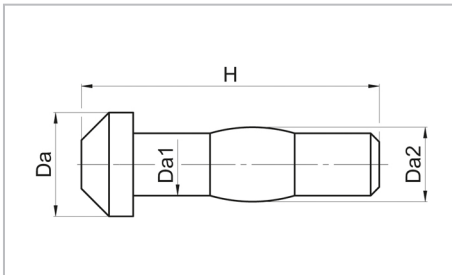

- Application only in Ex cable glands of following series:  
GHG9601955R00zz, GHG9601955R01zz, GHG9601955R005z, GHG9601956R00zz
- for secure sealing of Ex-cable glands into which no cables are installed

Group (Zone) II 2 G (1,2) II 2 D (21,22)  
Marking Ex e IIC Gb Ex tb IIIC Db  
Temperature range -55 °C / +70 °C  
Protection grade IP66 (if assembled properly, see Assembly instruction)  
Test standard EN IEC 60079-0:2018, IEC 60079-0:2017  
EN IEC 60079-7:2015+A1, IEC 60079-7:2015+A1  
EN 60079-31:2014, IEC 60079-31:2013  
EC-Type certificate PTB 14 ATEX 1015 X  
IECEX Certificate IECEX PTB 14.0027X



### Merkmale

### Characteristics

| Größe / size<br>xx | H<br>mm | Da<br>mm | Da1<br>mm | Da2<br>mm |  |  weiß<br>white<br>Art.-Nr. / Part No. |  rot<br>red<br>Art.-Nr. / Part No. |
|--------------------|---------|----------|-----------|-----------|---|--|---|
| M12                | 30,3    | 7        | 5         | 6         | 20  |  | GHG9601944R0101   |
| M16                | 33      | 8        | 6         | 7         | 20  |  | GHG9601944R0102   |
| M20                | 34,5    | 12       | 7         | 8,5       | 20  |  | GHG9601944R0103   |
| M25                | 36      | 16       | 10        | 11        | 20  |  | GHG9601944R0104   |
| M32                | 40      | 20       | 13        | 14        | 20  |  | GHG9601944R0105   |
| M40                | 42      | 24       | 19        | 20        | 10  | GHG9601944R0106  |   |
| M50                | 44      | 32       | 25        | 26        | 10  | GHG9601944R0107  |   |
| M63                | 45      | 39       | 32        | 34        | 5   | GHG9601944R0108  |   |