

Product End of Life Instructions

Lexium SD3 Stepper Motor Drive





Potential disassembly risks



DANGER

HAZARD OF ELECTRIC SHOCK, EXPLOSION OR ARC FLASH

- Disconnect all power from all equipment including connected devices prior to removing any covers or doors, or installing or removing any accessories, hardware, cables, or wires except under the specific conditions specified in the appropriate hardware guide for this equipment.
- Wait 5 minutes to allow the internal capacitors to discharge.
- Always use a properly rated voltage sensing device to confirm the power is off where and when indicated.

Failure to follow these instructions will result in death or serious injury.



End of Life Instructions

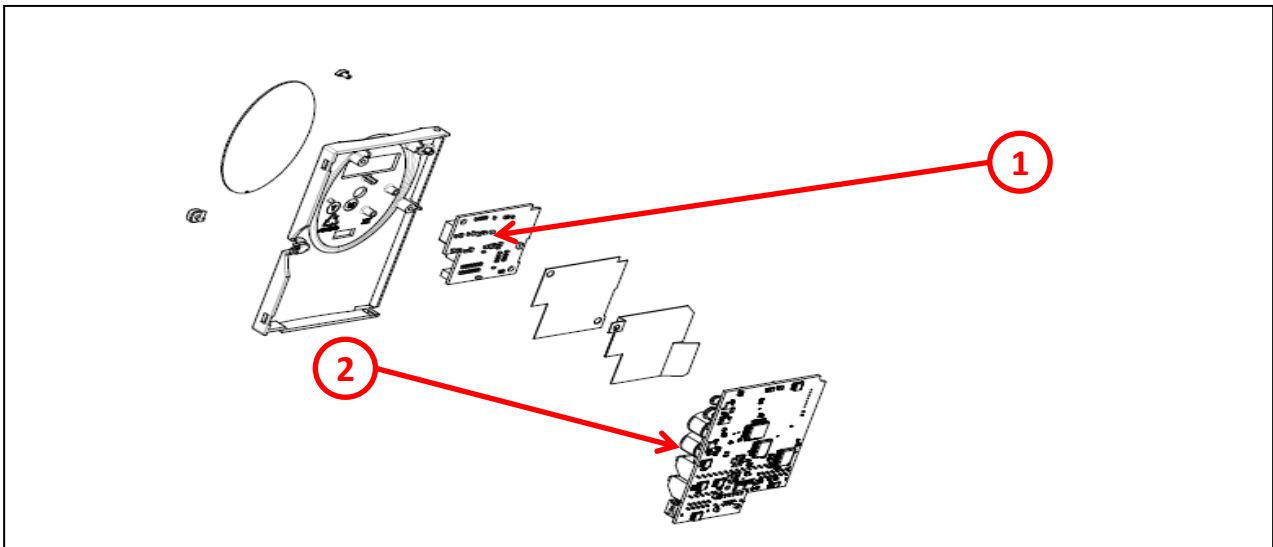

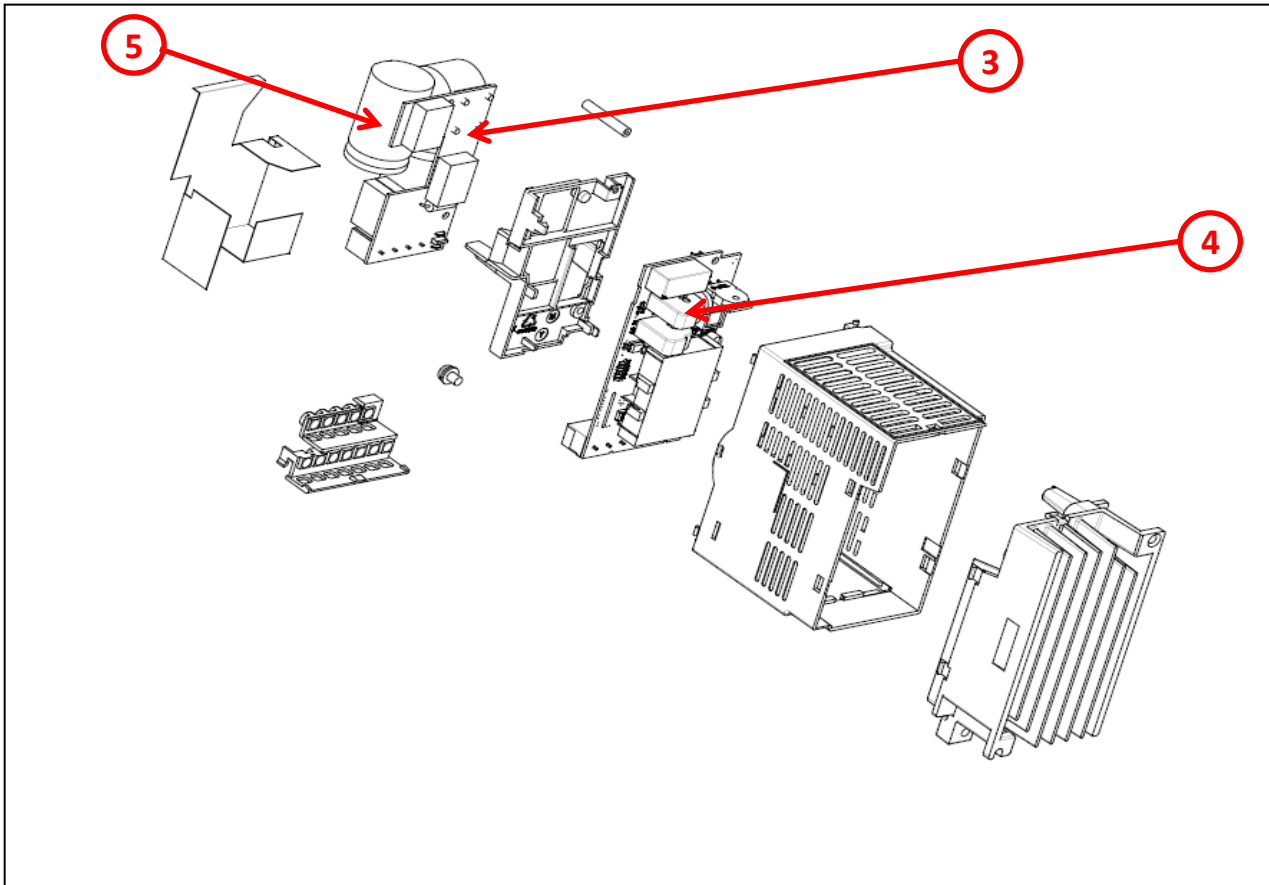

Recommendation	Number on drawing	Component / Material	Weight (in g)	Comment
To be depolluted	1	Electronic Board (Power) > 10cm ²	13	
To be depolluted	2	Electronic Board (Power) > 10cm ²	48.7	
To be depolluted	3	Electronic Board (Power) > 10cm ²	98	
To be depolluted	4	Electronic Board (Power) > 10cm ²	218	
To be depolluted	5	Electrolyte capacitors which size: height > 25 mm, diameter > 25 mm or proportionately similar volume	36	x2



Product description

Manufacturer identification	Schneider Electric Industries SAS
Brand name	Schneider Electric
Product reference	SD328BU25S2
Total representative product mass	1063 g
Representative product dimensions	72 x 145 x 140
Date of information release	10/2020



Additional information

Legal information

This product family is in the scope of European Union directive 2012/19/EU on Waste Electrical and Electronic Equipment (WEEE). The product family must be disposed according to the legislation of the country. This document is intended for use by end of life recyclers or treatment facilities. It provides the basic information to assure an appropriate end of life treatment for the components and materials of the product.

Recyclability potential

50%

Based on "ECO'DEEE recyclability and recoverability calculation method" (version V1, 20 Sep. 2008 presented to the French Agency for Environment and Energy Management: ADEME).

Schneider Electric Industries SAS

Country Customer Care Center
<http://www.schneider-electric.com/contact>

35, rue Joseph Monier
CS 30323
F- 92506 Rueil Malmaison Cedex
RCS Nanterre 954 503 439
Capital social 896 313 776 €

www.schneider-electric.com

ENVEOLI111103EN_V2

Published by Schneider Electric

© 2020 - Schneider Electric – All rights reserved

10/2020