

61802480	DATA SHEET	
Valid from: 03.07.2018	SILVYN® US-EDU-AS	

SILVYN® US-EDU-AS is an inner- / end sleeve for the installing form protection conduits on the gland SILVYN® US or as an end sleeve to prevent cable from being damaged, when there is no gland installation.



Material: Brass

Temperature range: -40°C up to +250°C

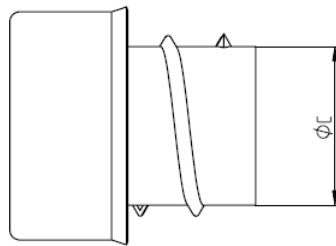

Dimension table:

Part No.	Part name	Nominal size	Conduit diameter mm		Diameter C mm
			Inner	Outer	
6180 2480	SILVYN® US-EDU-AS 7	10	7,0	10,0	6,0
6180 2490	SILVYN® US-EDU-AS 9	14	10,0	14,0	8,5
6180 2500	SILVYN® US-EDU-AS 11	17	13,0	17,0	11,5
6180 2510	SILVYN® US-EDU-AS 13,5	19	15,0	19,0	13,5
6180 2520	SILVYN® US-EDU-AS 16	21	17,0	21,0	15,5
6180 2530	SILVYN® US-EDU-AS 21	27	22,0	27,0	20,5
6180 2540	SILVYN® US-EDU-AS 29	36	29,0	36,0	27,5
6180 2550	SILVYN® US-EDU-AS 36	45	38,0	45,0	36,5
6180 2570	SILVYN® US-EDU-AS 48	56	49,0	56,0	47,5

Suitable conduits: SILVYN® AS-P
SILVYN® EDU-AS
SILVYN® EMC AS-CU

Suitable gland: SILVYN® US
SILVYN® US-M

For more information please see our current catalogue. Please do not hesitate to contact our laboratory if there are any questions regarding resistance against aggressive agents and special oil.

Creator: M. Wegerer /PDP Released: DAMU1/PDP	Document: DB61802480EN Version: 02	Page 1 of 1
---	---------------------------------------	-------------