

UTP	Cat 5e	C9080PC5EU
	Cat 6	C9080PC6U
	Cat 6A	C9080PC6AU
STP	Cat 6	C9080PC6S
	Cat 6A	C9080PC6AS

• Installazione • Installation • Installation • Instalação • Installazione

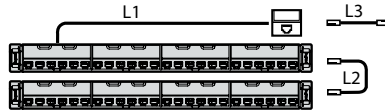



Cat 5e L1 ≤ 90 m
Cat 6 L2 + L3 ≤ 10 m
Cat 6A

• Cablaggio (AWG 22.....26) • Cabling (AWG 22 to 26) • Câblage (AWG 22.....26) • Cableado (AWG 22.....26) • Cablagem (AWG 22-26)

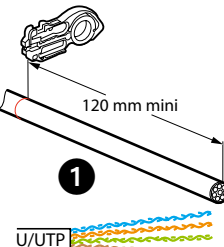
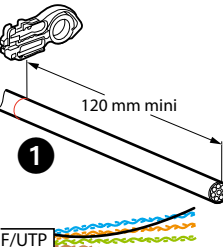
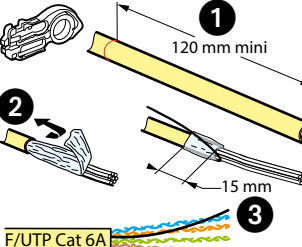
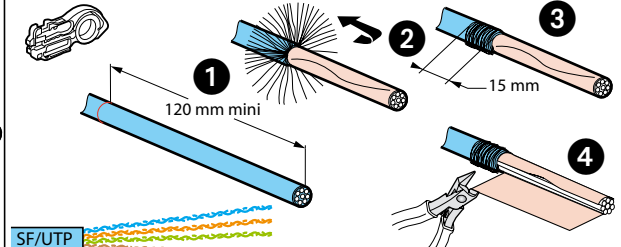
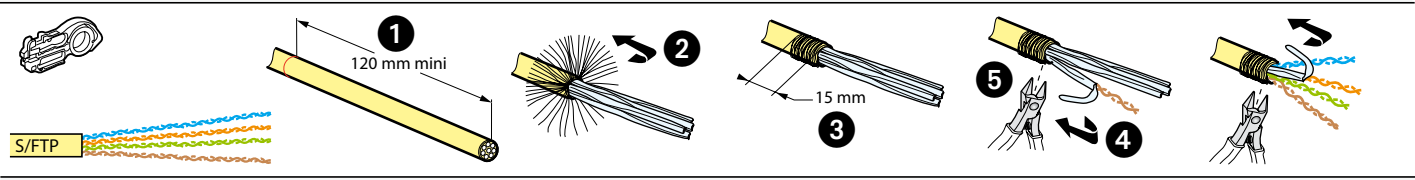
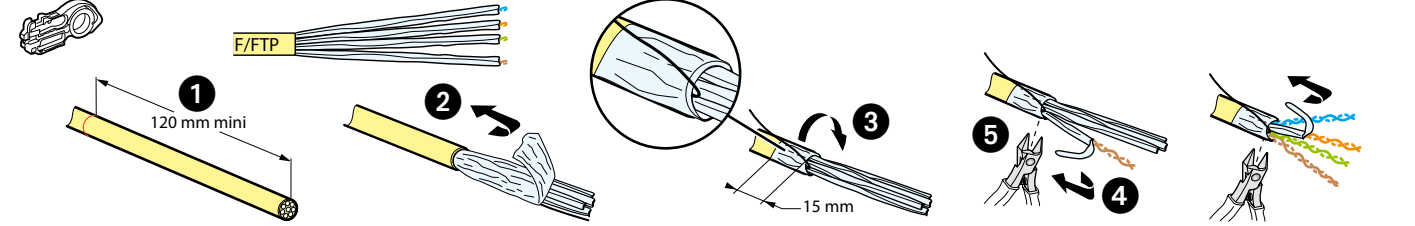
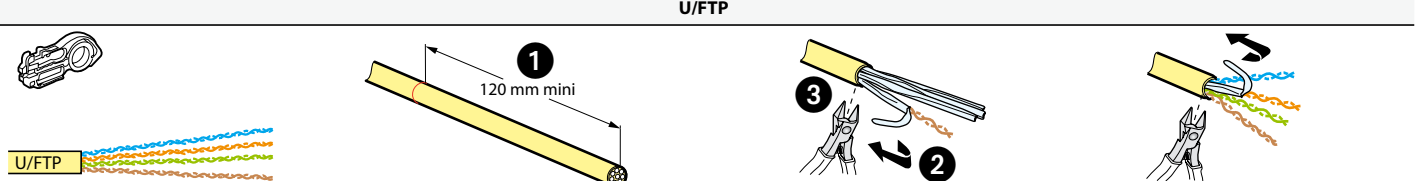
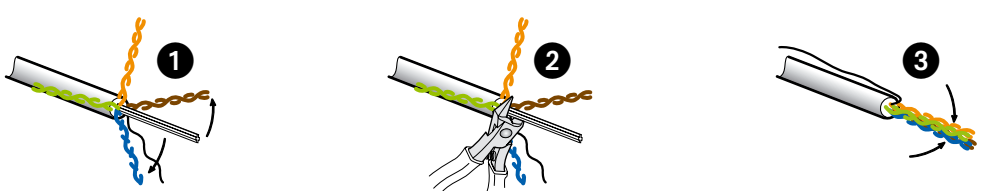
U/UTP	F/UTP	F/UTP Cat 6A	SF/UTP	S/FTP	F/FTP	U/FTP
						
						

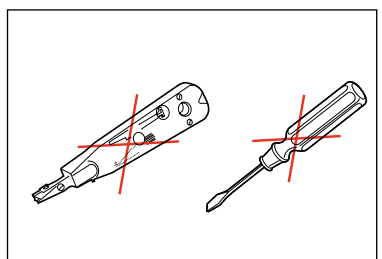
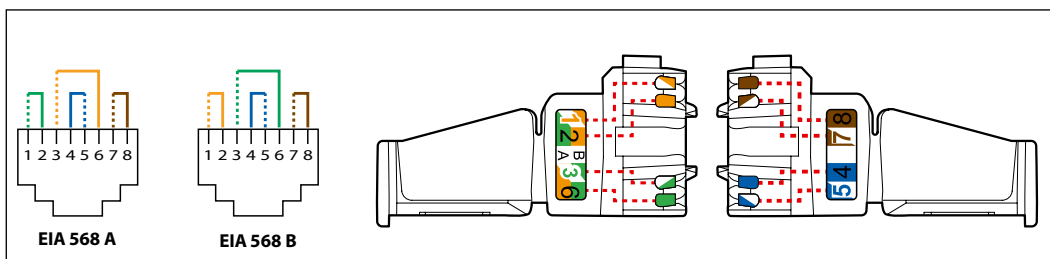

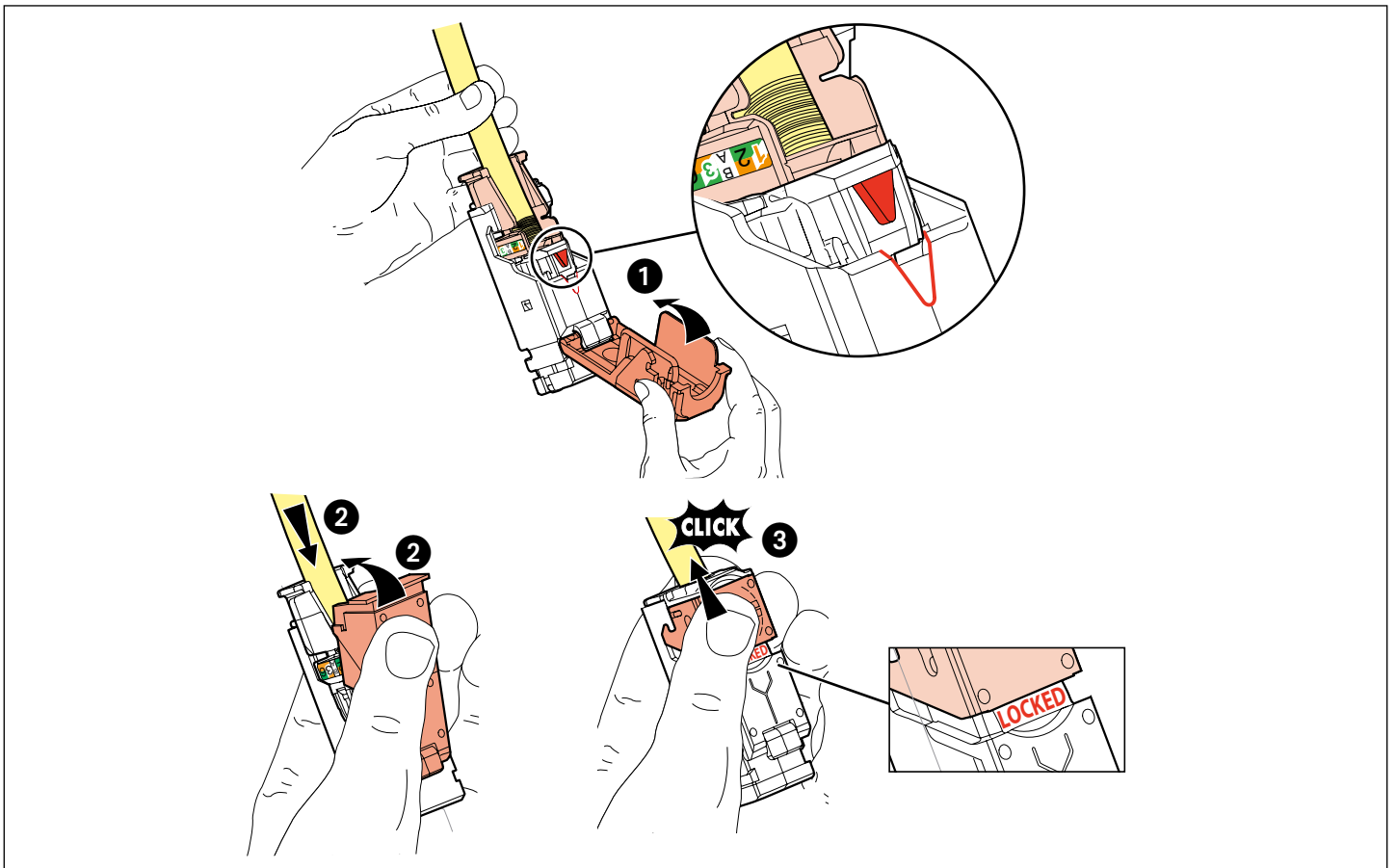
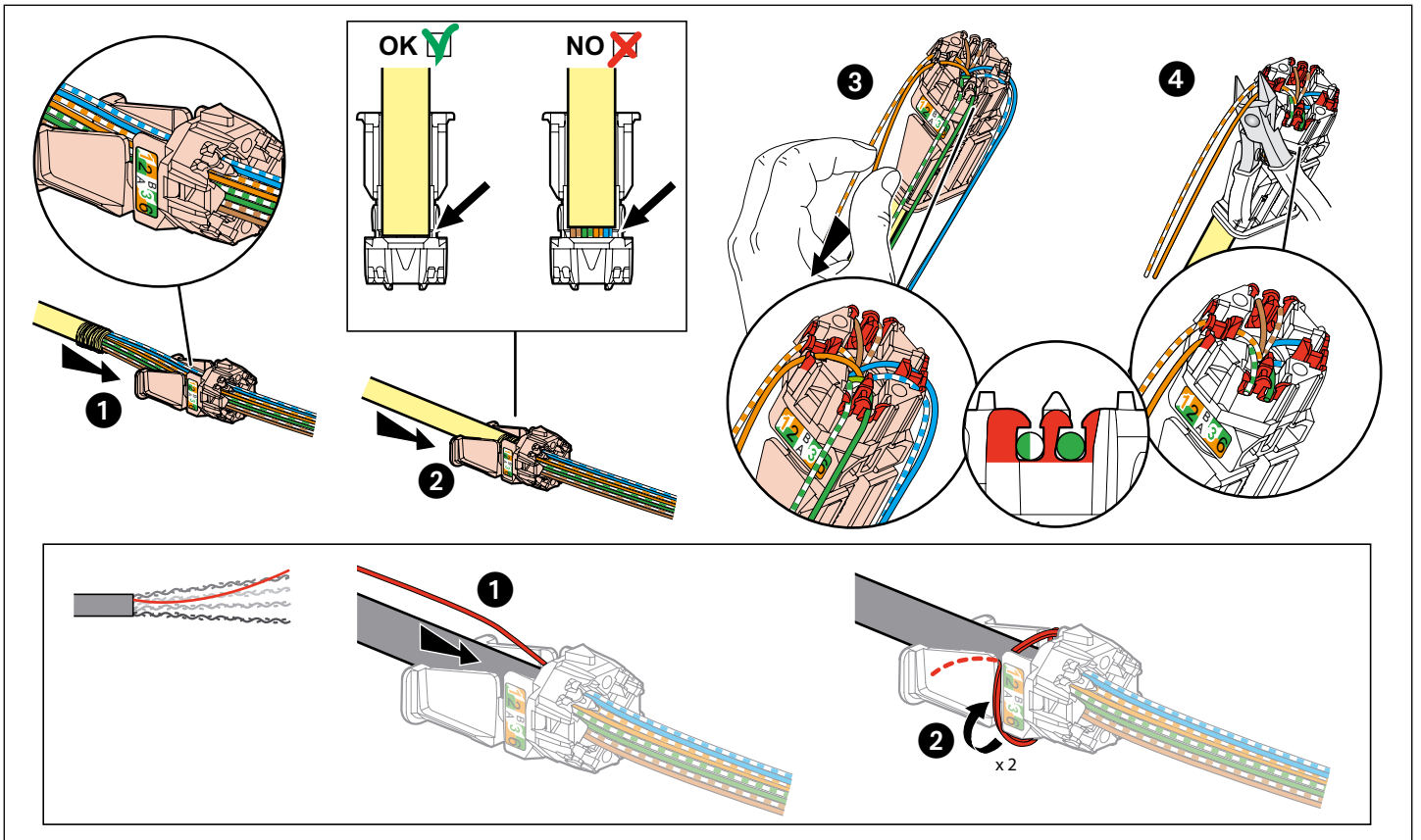

! Istruzioni di sicurezza
Prima di qualsiasi intervento, interrompere l'alimentazione.
Rispettare scrupolosamente le condizioni d'installazione e uso.

IT CH

! Safety instructions
Make sure the power supply is disconnected before any intervention.
Strictly comply with instructions for installation and use.

GB IE

! Consignes de sécurité
Avant toute intervention, couper le courant.
Respecter strictement les conditions d'installation et d'utilisation.

FR LU BE CH

! Consignas de seguridad
Antes de realizar cualquier intervención, cortar la corriente eléctrica.
Respetar estrictamente las condiciones de instalación y uso.

ES

! Antes de qualquer intervenção, desligar a corrente.
Respetar rigorosamente as condições de instalação e de utilização.

PT