

	29V _~
	20 mA
	4 x (Ø 0,6 mm < < Ø 0,8 mm)
	-5°C → +45°C
	PIR
	150 lux
	15 mn
	Auto ON/OFF
	Ø 5 m
	15 m

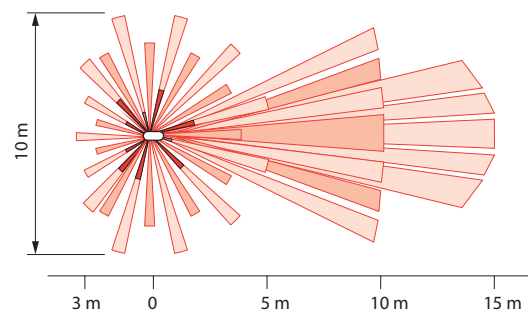

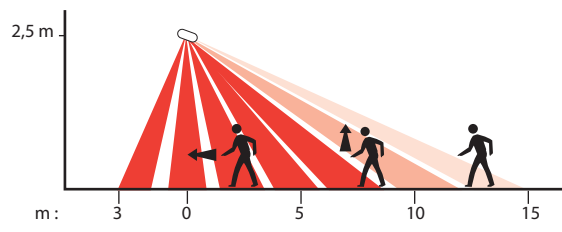

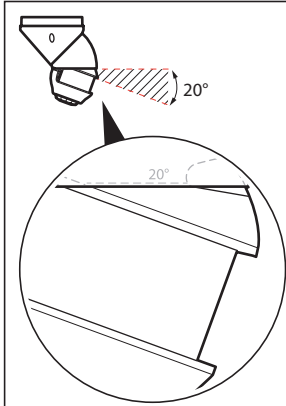

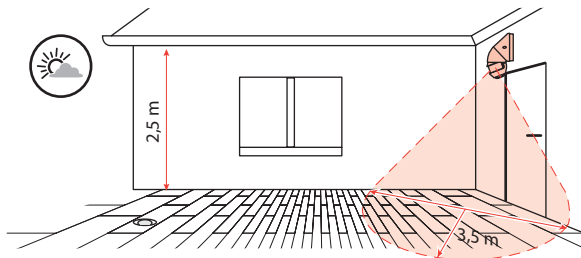
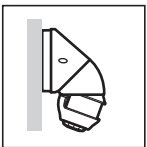
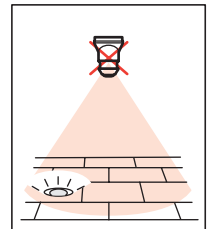
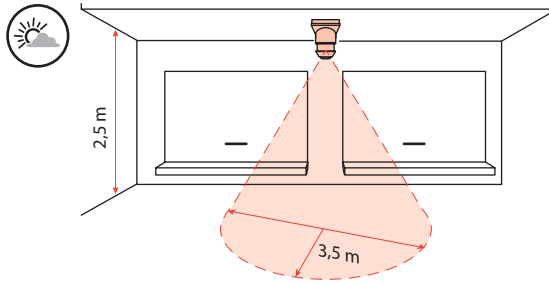
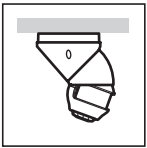
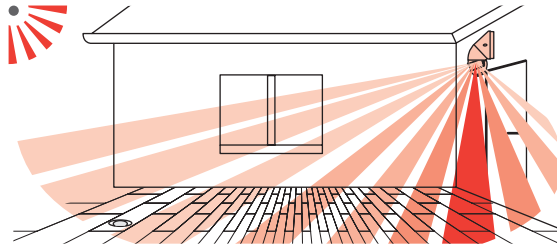
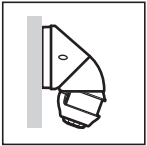
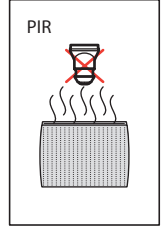
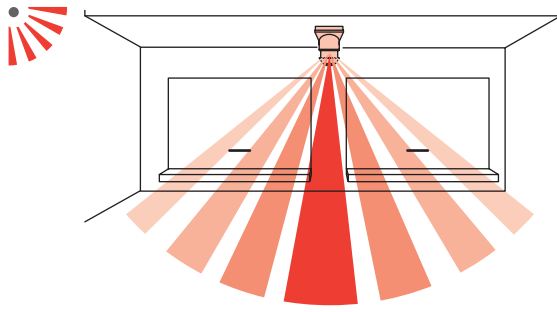
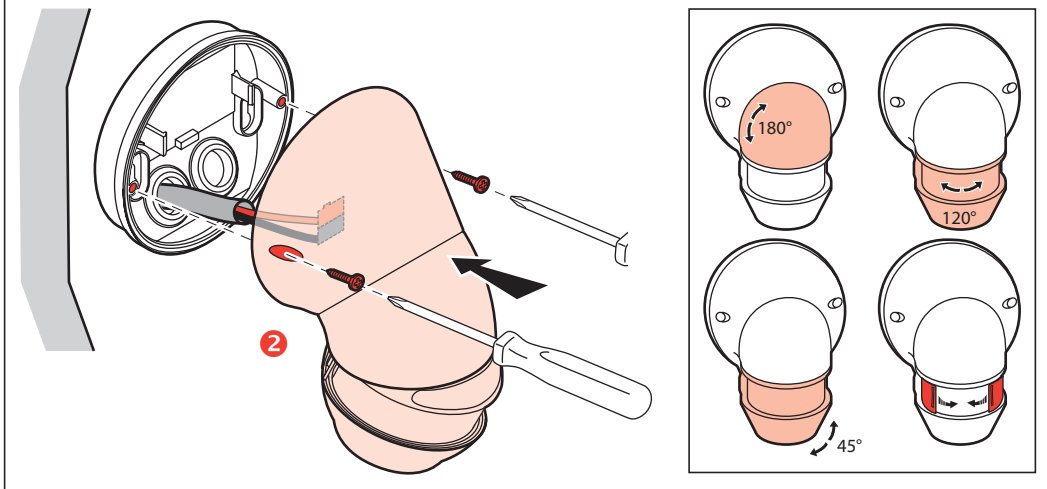
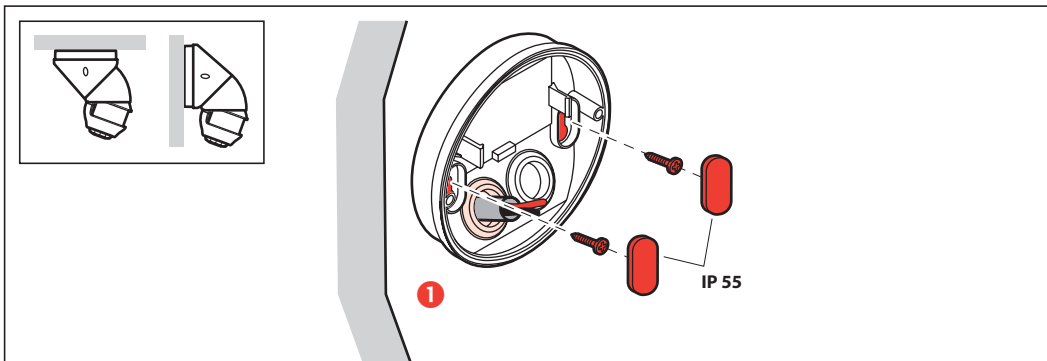
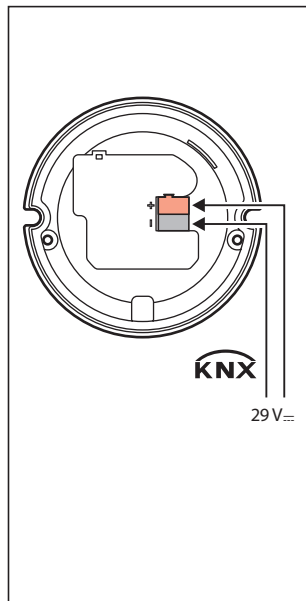
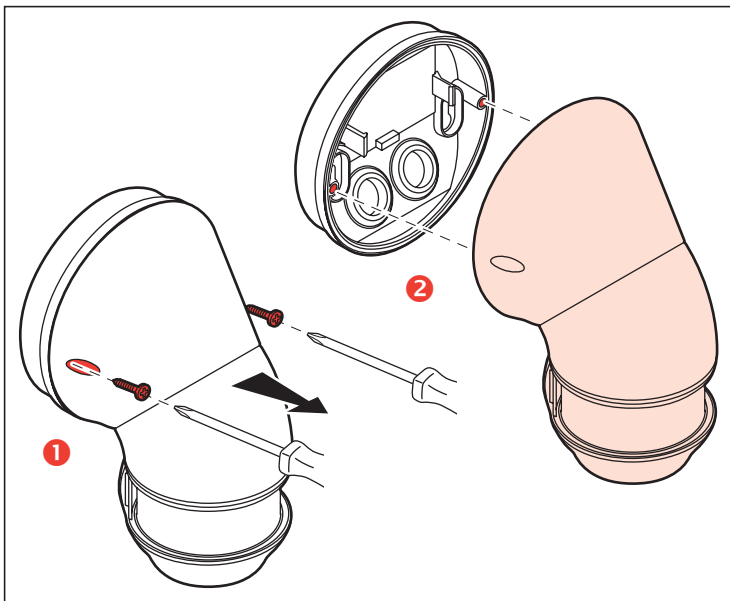
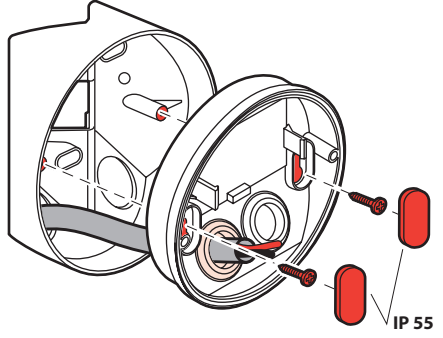
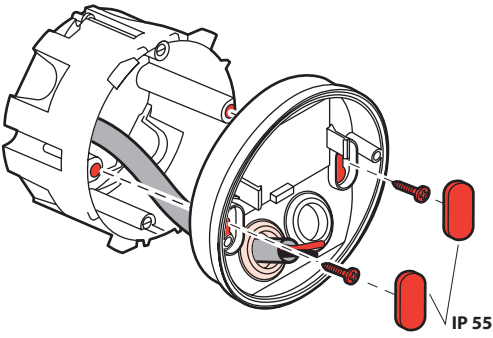
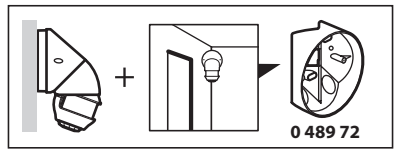
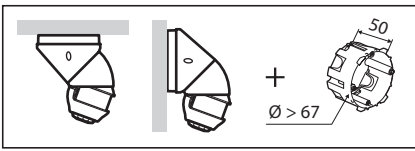

 **Auto ON/OFF**

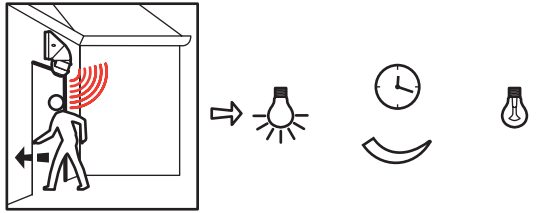
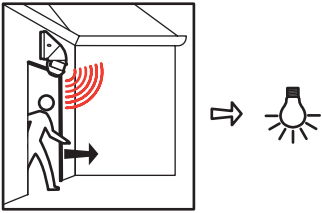

 **Manual ON / Auto OFF**

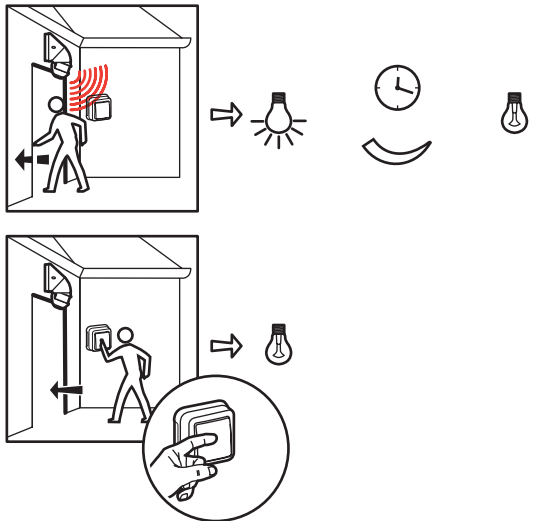
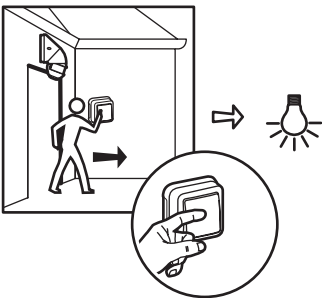



- À la première utilisation: Télécharger l'application Legrand Close Up sur l' Apple Store ou le Play Store.
- On first use: Download the Legrand Close Up app from Apple Store or Play Store
- Al primo utilizzo: Scaricare l'app Legrand Close Up su Apple Store o Play Store.

- Réf. 0 882 40 : Passerelle de configuration
- Cat. No(s) 0 882 40 : Configuration tool
- Ref. 0 882 40: Gateway di configurazione

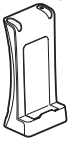

&



Application: «Legrand Close Up»



App Store



Google Play



- Pour plus de renseignements sur les paramètres, reportez vous à la fiche technique de la passerelle de configuration Réf. 0 882 40.
- For more information about setting parameters, refer to the data sheet for the configuration gateway Cat. No. 0 882 40.
- Per maggiori informazioni sulle impostazioni, consultare la scheda tecnica del gateway di configurazione Ref. 0 882 40.

	5 - 1275 lux
	5 sec - 18h00
	25% - 50% - 75% - 100%
Mode	Auto ON/OFF - Manual On/Auto OFF - Walk-through

- Détecteur/capteur PIR 180° à 270°
- PIR sensor 180° to 270°
- Sensore PIR 180° a 270°
- Cellule de luminosité
- Daylight sensor
- Cellula di luminosità
- Détecteur/capteur PIR 360°
- PIR sensor 360°
- Sensore PIR 360°

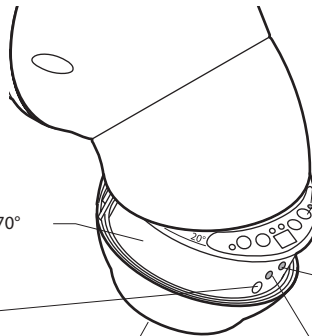

- LED KNX
- KNX LED
- LED KNX

- Bouton de prog. KNX
- KNX prog. push-button
- Pulsante prog. KNX

- LED de détection
- Motion led
- LED rilevazione movimento

- LED d'émission/de réception IR
- IR reception/transmission LED
- LED ricezione/trasmissione IR

