

Product Data Sheet

GW93357

90 MCB Range



Description HIGH PERFORMANCE MINIATURE CIRCUIT BREAKER

Code MTHP 160

No. of poles 1P

No. modules 1.5

Rated current 80 A

Curve D

Rated voltage 230-400 V

Standard	IEC/EN 60898-1, IEC/EN 60947-2	Rated frequency (Hz)	50/60 Hz
Breaking capacity EN 60898 230V (Icn)	10000 A	Breaking capacity EN 60898 400V (Icn)	10000 A
Breaking capacity EN 60898 (Ics)	0.75 x Icn	Breaking capacity IEC/EN 60947-2 230V (Icu)	16 kA
Breaking capacity IEC/EN 60947-2 400V (Icu)	4.5 kA	Breaking capacity IEC/EN 60947-2 (Ics)	50% Icu
Insulation voltage	500 V	Rated impulse withstand voltage	6 kV
Minimum operating voltage	12V ac/dc	Maximum operating voltage	440 V ac / 72 V dc
Electrical endurance	10.000	Mechanical endurance	20.000
Section rigid cable	<=1x70 - <=2x25 - <=2x25+1x10 mm ²	Section flexible cable	<=1x50 - <=2x25 - <=3x16 mm ²
Rated tightening torque	3.5 / 3 (terminals)	Operating temperature	-25 +60 °C
Stocking temperature	-40 +70 °C	Electrocod	1411

DIMENSIONAL

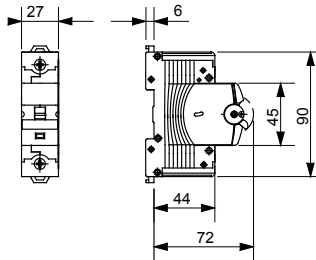

STANDARDS/APPROVALS



GEWISS S.p.A. Via A. Volta, 1
24069 Cenate Sotto - Bergamo - Italy
tel. +39 035 94 61 11 fax +39 035 94 69 09

www.gewiss.com
sat@gewiss.com
Last update 20/04/2023

Data, measures, designs and pictures are shown
only as informative purposes,
and could be changed without previous notice