

# Product Data Sheet

## GW90986

90 ReStart Range



Description Automatic reclosing device  
 Code ReStart Rm PRO 4P  
 Suitable for RCBO's MDC - 1P+N/2P/4P - 30 mA  
 Rated voltage AC 230 V  
 Rated current 6 - 10 - 13 - 16 - 20 -25 - 32 A  
 No. modules 3  
 Standard EN 50557  
 Rated frequency (Hz) 50Hz

Distribution system	TT - TN-S	Rated non-operating resistance between live parts and earth (Rdo)	8kΩ
Insulation voltage	500 V	Rated operating resistance between live parts and earth (Rd)	16 kΩ
Rated impulse withstand voltage	4 kV	Maximum operating frequency	30 oper./h
Overvoltage category	III	Mechanical endurance	4000
Dielectric strength test voltage between pole and earth	2500 Vac for 1 minute	Type of residual current protection	AC - A - A[IR]
Rated residual operating current	30 mA	Operating temperature	-25 +60 °C
Stocking temperature	-40 +70 °C	Type of contacts	Photomos (potential free)
Voltage operating	5-230 V ac/dc	Current operating	0.6mA (min)-100mA cosφ= 1 (max)
Operating frequency	50 Hz	Use category	AC12
Operating modes	NO/NC/NO with handle position signalling function	Rated tightening torque	0,4 Nm
Terminal section	≤ 2,5 mm²	Automatic reclosure for untimely tripping	Yes
Earth failure test	Yes	Continuous system monitoring	Yes
Complete with	One device among: GW90945 Wi-Fi Module - GWD0951 Auxiliary contact - GW90992 RS485 BUS Module	Electrocod	1413
Compatibility with WiFi interface	Yes		

### DIMENSIONAL

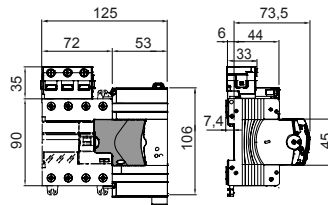

### STANDARDS/APPROVALS



GEWISS S.p.A. Via A. Volta, 1  
 24069 Cenate Sotto - Bergamo - Italy  
 tel. +39 035 94 61 11 fax +39 035 94 69 09

www.gewiss.com  
 sat@gewiss.com  
 Last update 20/04/2023

Data, measures, designs and pictures are shown only as informative purposes, and could be changed without previous notice