

# Signaling units Ø 70

Harmony<sup>®</sup> XVB modular tower lights

Catalog

September 2013



# How to find the “Automation and Control” products

## > Catalogs

Complete product ranges



## > Essential guides

Selection of the top selling products

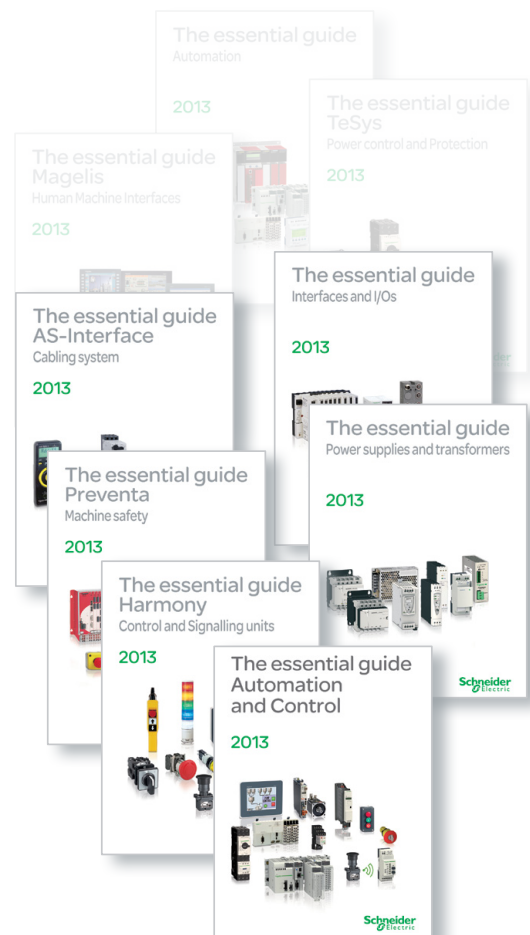

# General contents

## Harmony® XVB modular tower lights

**Selection guide** ..... page 2

### ■ Presentation

□ Illuminated beacons, tower lights for customer assembly ..... page 6

### ■ References

□ Illuminated beacons, type XVBL ..... page 8

□ Tower lights, type XVBC, for customer assembly, up to 5 units ..... page 11

□ Accessories for XVBL and XVBC ..... page 15

### ■ How to find the “Automation and Control” products

□ Search, visualize, and download ..... page 16

□ Access product references with adapted tools ..... page 18

□ Compare, select, and compile ..... page 20

□ Check the product status, design your equipment ..... page 21

■ **Product reference index** ..... page 22

Harmony® type XV **Monolithic tower lights**



<b>Type of products</b>	Complete pre-cabled pilot lights, height 55 mm/2.17 in.	Complete miniature beacons	Pre-assembled/pre-cabled tower lights Variable composition tower lights for customer assembly of up to 4 units
<b>Diameter</b>	Ø 25 mm/0.98 in.	Ø 45 mm/1.75 in.	Ø 60 mm/2.36 in.
<b>Degree of protection conforming to IEC 60529</b>	IP 40	IP 40	IP 53 and IP 42 (base mounting) IP 23 (direct aluminium tube mounting, aluminium tube mounting and "L" bracket) IP 53 and IP 42 (aluminium tube mounting and fixing plate) IP 40 (aluminium tube mounting and foldable bracket)
<b>Type of signalling</b>	Steady Flashing "Flash" Sound	– – Yes –	Yes – – With buzzer
<b>Light sources</b>	Incandescent bulb LED bulb Integral LED "Flash" discharge tube Halogen bulb	Yes – – Yes –	– – Yes – –
<b>Colors of illuminated units</b>	<input type="checkbox"/> Green <input type="checkbox"/> Red <input type="checkbox"/> Clear <input type="checkbox"/> Yellow	<input type="checkbox"/> Green <input type="checkbox"/> Red <input type="checkbox"/> Orange <input type="checkbox"/> Blue <input type="checkbox"/> Clear <input type="checkbox"/> Yellow	<input type="checkbox"/> Red <input type="checkbox"/> Green <input type="checkbox"/> Amber <input type="checkbox"/> Blue
<b>Connection</b>	Flying leads, length 360 mm/14.17 in.	Screw clamp terminals	Flying leads, length 500 to 560 mm/19.68 to 22.05 in. for tube mounting according to model. Length 900 mm/35.43 in. for base mounting.
<b>Support panel drilling or cut-out</b>	Ø 22 mm/0.87 in. or Ø 30 mm/1.18 in.	3 x Ø 3.3 mm/0.13 in. or M3	Base mounting: 3 x Ø 5 mm/0.20 in. Direct aluminium tube mounting: Ø 20/0.79 in. Aluminium tube mounting and "L" bracket: 2 x Ø 9/0.35 in. Aluminium tube mounting and fixing plate: 4 x Ø 6/0.24 in. Aluminium tube mounting and foldable bracket: 4 x Ø 6/0.24 in.
<b>Type references</b>	XV1CA	XVDLS	XVG



<b>Type of products</b>	Pre-assembled and pre-cabled tower lights	Pre-assembled and pre-cabled tower lights	Pre-assembled and pre-cabled tower lights	Pre-assembled and pre-cabled USB tower lights
<b>Diameter</b>	Ø 40 mm/1.57 in.	Ø 60 mm/2.36 in.	Ø 100 mm/3.94 in.	Ø 60 mm/2.36 in.
<b>Degree of protection conforming to IEC 60529</b>	IP 54 (flat surface installation) IP 23 (vertical surface installation)	IP 54 (flat surface installation) IP 23 (vertical surface installation)	IP 54 (flat surface installation)	IP 42
<b>Type of signalling</b>	Yes Yes – With buzzer	Yes Yes – With buzzer	Yes Yes – With siren or buzzer	Yes Yes – With buzzer (volume control and alarm type can be set with HMI)
<b>Light sources</b>	– – Yes – –	– – Yes – –	– – Yes – –	– – Yes – –
<b>Colors of illuminated units</b>	<input type="checkbox"/> Red <input type="checkbox"/> Orange <input type="checkbox"/> Green <input type="checkbox"/> Blue <input type="checkbox"/> Clear	<input type="checkbox"/> Red <input type="checkbox"/> Orange <input type="checkbox"/> Green <input type="checkbox"/> Blue <input type="checkbox"/> Clear	<input type="checkbox"/> Red <input type="checkbox"/> Orange <input type="checkbox"/> Green <input type="checkbox"/> Blue <input type="checkbox"/> Clear	Multi-color LEDs (many possible combinations can be set with HMI) <input type="checkbox"/> Red <input type="checkbox"/> Orange <input type="checkbox"/> Green <input type="checkbox"/> Blue
<b>Connection</b>	Flying leads, length 450 mm/17.71 in. to 900 mm/35.43 in. according to model	Flying leads, length 450 mm/17.71 in. to 850 mm/33.46 in. according to model	Flying leads, length 500 mm/19.68 in.	USB power cable: - 300 mm/11.81 in. for tube mounting - 400 mm/15.75 in. for direct mounting
<b>Support panel drilling or cut-out</b>	Mounting on support tube with bracket: 2 x Ø 9 mm/0.35 in. Direct mounting on horizontal support: 3 x Ø 5 mm/0.20 in. Other mounting possibilities with accessories	Mounting on support tube with bracket: 2 x Ø 11 mm/0.43 in. Direct mounting on horizontal support: 3 x Ø 5 mm/0.20 in. Other mounting possibilities with accessories	Direct mounting on horizontal support: - 3 x Ø 6 mm/0.24 in. (without siren) - 3 x Ø 7 mm/0.28 in. (with siren) Other mounting possibilities with accessories	Mounting on support tube with fixing plate: 4 x Ø 6 mm/0.24 in. Direct mounting on horizontal support: 3 x Ø 5 mm/0.20 in.
<b>Type references</b>	XVC4	XVC6	XVC1	XVGU

Harmony® type XV **Modular tower lights**



<b>Type of products</b>	Pre-assembled/pre-cabled tower lights Variable composition tower lights for customer assembly of up to 5 units	Tower lights for customer assembly of up to 5 units.
<b>Diameter</b>	Ø 45 mm/1.77 in.	Ø 60 mm/2.36 in.
<b>Degree of protection conforming to IEC 60529</b>	IP 54 in vertical position (XVM with plastic fixing plate) IP 42 in horizontal position (XVM with metal bracket) IP 40 in other positions (all types of XVM tower lights)	IP 65 for illuminated units IP 54 for audible units IP 55 for flexible mounting option
<b>Type of signalling</b>	Steady Flashing "Flash" Sound	Yes Yes Yes Yes
<b>Light sources</b>	Incandescent bulb LED bulb Integral LED "Flash" discharge tube Halogen bulb	– – Yes – –
<b>Colors of illuminated units</b>	<input type="checkbox"/> Red <input type="checkbox"/> Green <input type="checkbox"/> Orange <input type="checkbox"/> Blue <input type="checkbox"/> Clear	<input type="checkbox"/> Green <input type="checkbox"/> Red <input type="checkbox"/> Orange <input type="checkbox"/> Blue <input type="checkbox"/> White <input type="checkbox"/> Yellow (only for multi-color unit with above colors)
<b>Connection</b>	Flying leads, length 300 mm/11.81 in. or screw terminals	Spring cage connection terminals
<b>Support panel drilling or cut-out</b>	Mounting on bracket: 2 x Ø 9 mm /0.35 in. Mounting on support tube: 4 x Ø 5.5 mm/0.22 in. or M5	Mounting on support tube and adjustable support tube: 4 x Ø 6 mm/0.24 in.  Direct mounting and Flexible wall mounting: 3 x Ø 5 mm/0.196 in.
<b>Type references</b>	<b>XVM</b>	<b>XVU</b>

**Rotating beacons** **Sound solutions**



<b>Type of products</b>	Illuminated beacons Variable composition tower lights for customer assembly of up to 5 units	Pre-cabled rotating beacons	Sirens and electronic alarms
<b>Diameter</b>	Ø 70 mm/2.76 in.	Ø 84 mm/3.31 in. to Ø 130 mm/5.12 in.	–
<b>Degree of protection conforming to IEC 60529</b>	IP 65 (mounted on fixing base XVBZ0●) IP 66 (mounted on base unit)	Ø 84 mm/3.31 in. and Ø 106 mm/4.17 in.: IP 23 (IP 65 with accessory) Ø 120 mm/4.72 in.: IP 23 Ø 130 mm/5.12 in.: IP 66 and IP 67 (depending on voltage)	IP 53 (sirens) IP 54 (electronic alarms)
<b>Type of signalling</b>	Yes Yes Yes Yes	Yes – – Yes	– – – Yes
<b>Light sources</b>	Yes "PROTECTED LED" "PROTECTED LED" Yes –	– "Super Bright" – – Yes	– – – –
<b>Colors of illuminated units</b>	<input type="checkbox"/> Green <input type="checkbox"/> Red <input type="checkbox"/> Orange <input type="checkbox"/> Blue <input type="checkbox"/> Clear <input type="checkbox"/> Yellow	<input type="checkbox"/> Red <input type="checkbox"/> Orange <input type="checkbox"/> Green <input type="checkbox"/> Blue	–
<b>Connection</b>	Screw clamp terminals	Flying leads, length 400 mm/15.75 in. (except XVR08: 500 mm/19.68 in.)	Screw clamp terminals (except XVS14: flying leads, length 500 mm/19.68 in.)
<b>Support panel drilling or cut-out</b>	Mounting on support tube: 4 x Ø 5.5 mm/0.22 in. or M5 Vertical mounting: 3 x Ø 5 mm/0.20 in. or M5 Direct mounting: 2 x Ø 4.5 mm/0.18 in. or M4	Depending on model: – XVR08 (Ø 84 mm/3.31 in.): 3 x Ø 5 mm/0.20 in. – XVR10 (Ø 106 mm/5.12 in.): 3 x Ø 5 mm/0.20 in. – XVR12 (Ø 120 mm/4.72 in.): 3 x Ø 6 mm/0.24 in. – XVR13 (Ø 130 mm/5.12 in.): 3 x Ø 9 mm/0.35 in. – XVR13●●L (Ø 130 mm/5.12 in.): 3 x Ø 7 mm/0.28 in.	3 x Ø 6.5 mm/0.25 in.
<b>Type references</b>	<b>XVBL, XVBC</b>	<b>XVR</b>	<b>XVS</b>

# Signaling Units

Modular tower lights

Harmony® type XVB Ø 70

Illuminated beacons, tower lights for customer assembly (up to 5 units)

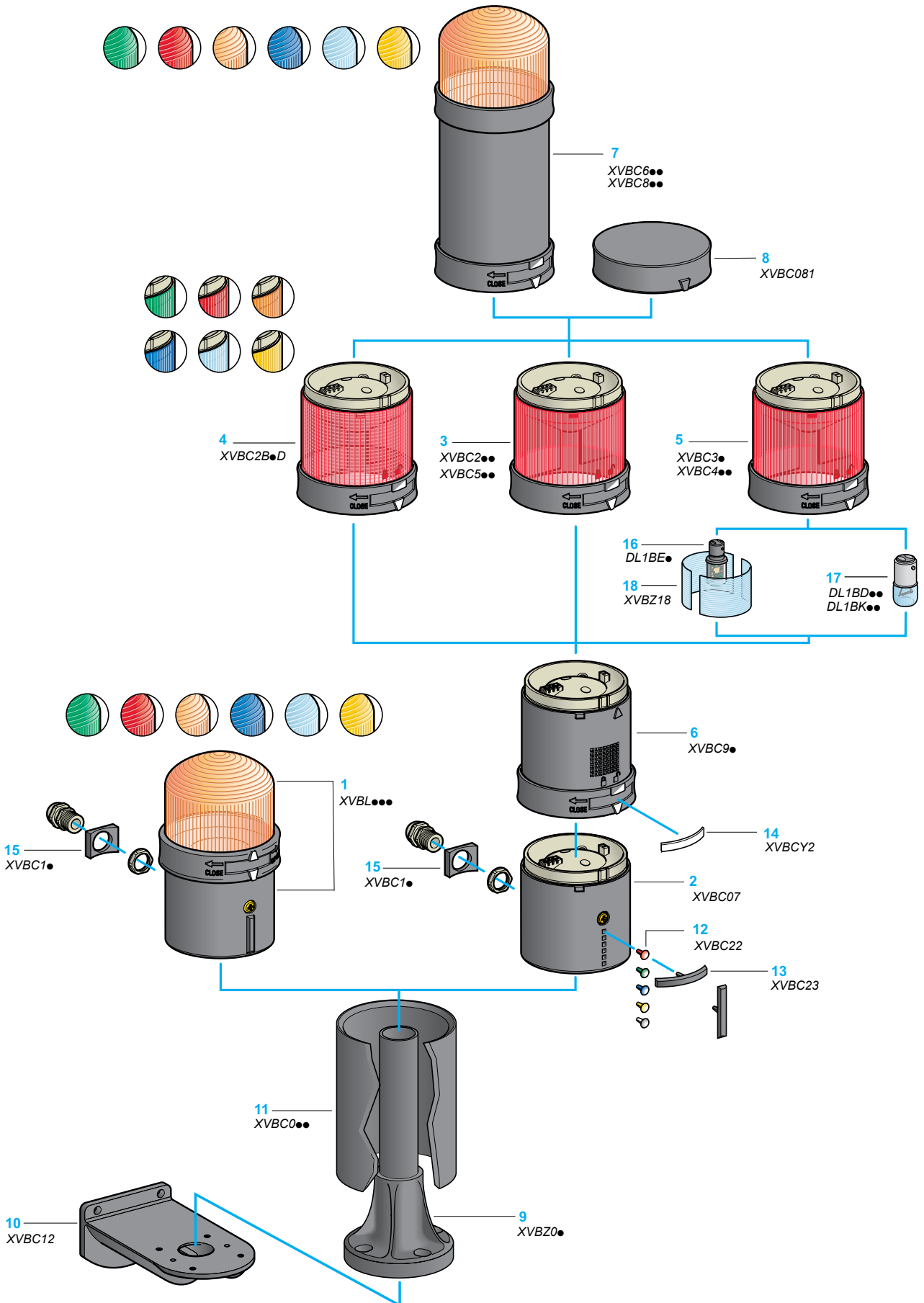

# Signaling Units

## Modular tower lights

### Harmony® type XVB Ø 70

Illuminated beacons, tower lights for customer assembly  
(up to 5 units)

#### Presentation

The beacons and tower lights of the Harmony® XVB range are visual or audible signaling units used for indicating, throughout 360° and at a distance, the various states or operation sequences of a machine or installation. Examples: start, stop machine, no material, call technical staff, fault signaling, etc.

#### Complete illuminated beacon XVBL

Readily assembled 1 with a single illuminated signaling unit:

- steady light (with incandescent bulb or LED),
- flashing light (with incandescent bulb or LED),
- or "flash" (with discharge tube).

The XVBL beacons comprise:

- A base unit with a removable terminal block and a bottom or side cable entry.
- One colored illuminated unit (green, red, orange, blue, clear or yellow).

#### Customer assembled tower light XVBC

Variable composition of 1 to 5 illuminated or audible units that are supplied as separate items for customer assembly. Maximum configuration: 5 units or 4 units + 1 "flash" unit.

The XVBC tower lights comprise:

- A base unit with a removable terminal block and bottom or side cable entry 2.
- 1 to 5 colored illuminated units (green, red, orange, blue, clear or yellow):
  - with integral LED 3,
  - with integral LED and diffuser 4 (1),
  - for incandescent bulbs or base mounted LEDs 5.
- 1 or 2 audible units 6.
- A maximum of 1 "flash" discharge unit (5 Joule or 10 Joule) 7, for mounting on top of the bank.
- A top cover 8 (except when using a "flash" discharge tube).
- The illuminated or audible units stack vertically and are easily locked and unlocked using an integral clamping ring. Electrical connections between each unit are made automatically.
- A light diffuser, pre-fitted in illuminated units XVBC2B•D with a base mounted LED, distributes the light evenly over the lens surface. When using the modular tower lights in bright ambient light conditions, remove the diffuser to improve contrast.
- Connection on the AS-Interface cabling system is possible by ordering a dedicated base unit. For more information on AS-Interface, please see our website [www.schneider-electric.com](http://www.schneider-electric.com).

#### Accessories for beacons XVBL and tower lights XVBC

- Fixing base comprising a support tube glued into a plastic fixing plate, for a height beneath the base unit of 80, 380 or 780 mm 9.
- Fixing plate for mounting on vertical support 10.
- Support tube concealment cover, height 100, 400 or 800 mm 11.
- Colored markers 12 (1).
- Legend holder with legend 13 (1).
- Legends that attach to locking ring of each signaling unit for identification 14.
- Adaptor and 13P cable gland 15.
- Base mounted LED 16 or incandescent bulb 17 (2).
- Diffuser 18 (3).

#### Mounting, protection and conformity to standards

- Base unit fixed directly onto a panel using 2 screws (IP 66 protection).
- Fixed using a fixing base comprising of an aluminium support tube glued into a plastic fixing plate (IP 65 protection).
- Conformity to EN/IEC 60947-5-1 standard.
- Product certified UL, CSA, CCC and GOST.

#### Cabling

By means of removable terminal block incorporated in base unit (simplified wiring). The screw and captive cable clamp terminals are protected to prevent any accidental contact with live parts.

(1) These enable the position of the various units (illuminated or audible) to be identified in the event of dismantling the bank.

(2) **Warning:** illuminated units with incandescent bulbs must not be combined with LED illuminated units, due to the risk of overheating. Also, when different units (e.g. steady, flashing,) are combined, the maximum temperature is limited to that of the weaker unit.

(3) The diffuser can only be used with LED illuminated units. Not compatible with units fitted with an incandescent bulb or "flash" discharge tube.

# Signaling Units

Modular tower lights

Harmony® type XVBL Ø 70

Illuminated beacons for incandescent bulbs or LEDs  
(BA 15d base fitting)



XVBL3●



XVBL4B●

### Illuminated beacons with steady light signaling

Description	Light source, to be ordered separately (1)	Color	Reference	Weight kg
<b>Complete unit comprising:</b> - 1 illuminated unit - 1 base unit for direct fixing (IP 66) or tube fixing (IP 65)	Incandescent bulb 7 W max. 250 V max.	Green	<b>XVBL33</b>	0.260
		Red	<b>XVBL34</b>	0.260
		Orange	<b>XVBL35</b>	0.260
		Blue	<b>XVBL36</b>	0.260
		Clear	<b>XVBL37</b>	0.260
		Yellow	<b>XVBL38</b>	0.260

### Illuminated beacons with integral flashing light signaling

Description	Light source, to be ordered separately (1)	Color	Reference	Weight kg	
<b>Complete unit comprising:</b> - 1 illuminated unit - 1 base unit for direct fixing (IP 66) or tube fixing (IP 65)	Incandescent bulb 7 W max. ~ 24 V --- 24...48 V	Green	<b>XVBL4B3</b>	0.280	
		Red	<b>XVBL4B4</b>	0.280	
		Orange	<b>XVBL4B5</b>	0.280	
		Blue	<b>XVBL4B6</b>	0.280	
		Clear	<b>XVBL4B7</b>	0.280	
		Yellow	<b>XVBL4B8</b>	0.280	
		Incandescent bulb 7 W max. ~ 48...230 V	Green	<b>XVBL4M3</b>	0.280
			Red	<b>XVBL4M4</b>	0.280
Orange	<b>XVBL4M5</b>		0.280		
Blue	<b>XVBL4M6</b>		0.280		
Clear	<b>XVBL4M7</b>		0.280		
Yellow	<b>XVBL4M8</b>		0.280		

(1) Incandescent bulbs and LEDs, see page 15.



# Signaling Units

Modular tower lights

Harmony® type XVBL Ø 70

Illuminated beacons with LED light source

1014075E



XVBL0B●

PF110465



XVBL1B●

## Illuminated beacons with steady light signaling

Description	Light source	Color	Reference	Weight kg	
<b>Complete unit comprising:</b> - 1 illuminated unit - 1 base unit for direct fixing (IP 66) or tube fixing (IP 65)	LED, included ~ 24 V	Green	<b>XVBL0B3</b>	0.270	
		Red	<b>XVBL0B4</b>	0.270	
		Orange	<b>XVBL0B5</b>	0.270	
		Blue	<b>XVBL0B6</b>	0.270	
		Clear	<b>XVBL0B7</b>	0.270	
		Yellow	<b>XVBL0B8</b>	0.270	
		LED, included ~ 120 V	Green	<b>XVBL0G3</b>	0.270
			Red	<b>XVBL0G4</b>	0.270
Orange	<b>XVBL0G5</b>		0.270		
Blue	<b>XVBL0G6</b>		0.270		
Clear	<b>XVBL0G7</b>		0.270		
Yellow	<b>XVBL0G8</b>		0.270		
LED, included ~ 230 V	Green		<b>XVBL0M3</b>	0.270	
	Red		<b>XVBL0M4</b>	0.270	
	Orange	<b>XVBL0M5</b>	0.270		
	Blue	<b>XVBL0M6</b>	0.270		
	Clear	<b>XVBL0M7</b>	0.270		
	Yellow	<b>XVBL0M8</b>	0.270		

Protected  
LED

## Illuminated beacons with integral flashing light signaling

Description	Light source	Color	Reference	Weight kg	
<b>Complete unit comprising:</b> - 1 illuminated unit - 1 base unit for direct fixing (IP 66) or tube fixing (IP 65)	LED, included ~ 24 V	Green	<b>XVBL1B3</b>	0.280	
		Red	<b>XVBL1B4</b>	0.280	
		Orange	<b>XVBL1B5</b>	0.280	
		Blue	<b>XVBL1B6</b>	0.280	
		Clear	<b>XVBL1B7</b>	0.280	
		Yellow	<b>XVBL1B8</b>	0.280	
		LED, included ~ 120 V	Green	<b>XVBL1G3</b>	0.280
			Red	<b>XVBL1G4</b>	0.280
Orange	<b>XVBL1G5</b>		0.280		
Blue	<b>XVBL1G6</b>		0.280		
Clear	<b>XVBL1G7</b>		0.280		
Yellow	<b>XVBL1G8</b>		0.280		
LED, included ~ 230 V	Green		<b>XVBL1M3</b>	0.280	
	Red		<b>XVBL1M4</b>	0.280	
	Orange	<b>XVBL1M5</b>	0.280		
	Blue	<b>XVBL1M6</b>	0.280		
	Clear	<b>XVBL1M7</b>	0.280		
	Yellow	<b>XVBL1M8</b>	0.280		

Protected  
LED

# Signaling Units

Modular tower lights

Harmony® type XVBL Ø 70

Illuminated beacons with “flash” discharge tube



XVBL6B●



XVBL8B●

### Illuminated beacons with 5 Joule “flash” discharge tube

Description	Light source	Color	Reference	Weight kg
<b>Complete unit comprising:</b> - 1 illuminated unit - 1 base unit for direct fixing (IP 66) or tube fixing (IP 65)	Integral “flash” discharge tube ~ 24 V	Green	<b>XVBL6B3</b>	0.440
		Red	<b>XVBL6B4</b>	0.440
		Orange	<b>XVBL6B5</b>	0.440
		Blue	<b>XVBL6B6</b>	0.440
		Clear	<b>XVBL6B7</b>	0.440
		Yellow	<b>XVBL6B8</b>	0.440
Integral “flash” discharge tube ~ 120 V	Integral “flash” discharge tube ~ 120 V	Green	<b>XVBL6G3</b>	0.425
		Red	<b>XVBL6G4</b>	0.425
		Orange	<b>XVBL6G5</b>	0.425
		Blue	<b>XVBL6G6</b>	0.425
		Clear	<b>XVBL6G7</b>	0.425
		Yellow	<b>XVBL6G8</b>	0.425
Integral “flash” discharge tube ~ 230 V	Integral “flash” discharge tube ~ 230 V	Green	<b>XVBL6M3</b>	0.435
		Red	<b>XVBL6M4</b>	0.435
		Orange	<b>XVBL6M5</b>	0.435
		Blue	<b>XVBL6M6</b>	0.435
		Clear	<b>XVBL6M7</b>	0.435
		Yellow	<b>XVBL6M8</b>	0.435

### Illuminated beacons with 10 Joule “flash” discharge tube

Description	Light source	Color	Reference	Weight kg
<b>Complete unit comprising:</b> - 1 illuminated unit - 1 base unit for direct fixing (IP 66) or tube fixing (IP 65)	Integral “flash” discharge tube ~ 24 V	Green	<b>XVBL8B3</b>	0.450
		Red	<b>XVBL8B4</b>	0.450
		Orange	<b>XVBL8B5</b>	0.450
		Blue	<b>XVBL8B6</b>	0.450
		Clear	<b>XVBL8B7</b>	0.450
		Yellow	<b>XVBL8B8</b>	0.450
Integral “flash” discharge tube ~ 120 V	Integral “flash” discharge tube ~ 120 V	Green	<b>XVBL8G3</b>	0.460
		Red	<b>XVBL8G4</b>	0.460
		Orange	<b>XVBL8G5</b>	0.460
		Blue	<b>XVBL8G6</b>	0.460
		Clear	<b>XVBL8G7</b>	0.460
		Yellow	<b>XVBL8G8</b>	0.460
Integral “flash” discharge tube ~ 230 V	Integral “flash” discharge tube ~ 230 V	Green	<b>XVBL8M3</b>	0.460
		Red	<b>XVBL8M4</b>	0.460
		Orange	<b>XVBL8M5</b>	0.460
		Blue	<b>XVBL8M6</b>	0.460
		Clear	<b>XVBL8M7</b>	0.460
		Yellow	<b>XVBL8M8</b>	0.460

For use with base unit XVBC●●: see page 14

## Signaling Units

Modular tower lights

Harmony® type XVBC Ø 70

Tower lights for customer assembly (up to 5 units)

Illuminated units for incandescent bulbs or LEDs (BA 15d base fitting)



XVBC3●



XVBC4●●

### Illuminated units with steady light signaling

Description	Light source, to be ordered separately (1)	Color	Reference	Weight kg
Illuminated units	Incandescent bulb 7 W max. 250 V max. or LED	Green	<b>XVBC33</b>	0.140
		Red	<b>XVBC34</b>	0.140
		Orange	<b>XVBC35</b>	0.140
		Blue	<b>XVBC36</b>	0.140
		Clear	<b>XVBC37</b>	0.140
		Yellow	<b>XVBC38</b>	0.140

### Illuminated units with integral flashing light signaling

Description	Light source, to be ordered separately (1)	Color	Reference	Weight kg	
Illuminated units	Incandescent bulb 7 W max. ~ 24 V ~ 24...48 V or LED	Green	<b>XVBC4B3</b>	0.160	
		Red	<b>XVBC4B4</b>	0.160	
		Orange	<b>XVBC4B5</b>	0.160	
		Blue	<b>XVBC4B6</b>	0.160	
		Clear	<b>XVBC4B7</b>	0.160	
		Yellow	<b>XVBC4B8</b>	0.160	
		Incandescent bulb 7 W max. ~ 48...230 V or LED	Green	<b>XVBC4M3</b>	0.160
			Red	<b>XVBC4M4</b>	0.160
Orange	<b>XVBC4M5</b>		0.160		
Blue	<b>XVBC4M6</b>		0.160		
Clear	<b>XVBC4M7</b>		0.160		
Yellow	<b>XVBC4M8</b>		0.160		

(1) Incandescent bulbs and LEDs, see page 15.

# Signaling Units

Modular tower lights

Harmony® type XVBC Ø 70

Tower lights for customer assembly (up to 5 units)

Illuminated units with integral LED

For use with base unit XVBC●●: see page 14



XVBC2●●



XVBC5●●

### Illuminated units with steady light signaling

Description	Voltage	Color	Reference	Weight kg	
Illuminated units with integral LED	≈ 24 V	Green	XVBC2B3 (1)	0.150	
		Red	XVBC2B4 (1)	0.150	
		Orange	XVBC2B5 (1)	0.150	
		Blue	XVBC2B6 (1)	0.150	
		Clear	XVBC2B7 (1)	0.150	
		Yellow	XVBC2B8 (1)	0.150	
		~ 120 V	Green	XVBC2G3	0.150
			Red	XVBC2G4	0.150
Orange	XVBC2G5		0.150		
Blue	XVBC2G6		0.150		
Clear	XVBC2G7		0.150		
Yellow	XVBC2G8		0.150		
~ 230 V	Green		XVBC2M3	0.150	
	Red		XVBC2M4	0.150	
	Orange	XVBC2M5	0.150		
	Blue	XVBC2M6	0.150		
	Clear	XVBC2M7	0.150		
	Yellow	XVBC2M8	0.150		

Protected LED

### Illuminated units with integral flashing light signaling

Description	Voltage	Color	Reference	Weight kg	
Illuminated units with integral LED	≈ 24 V	Green	XVBC5B3	0.170	
		Red	XVBC5B4	0.170	
		Orange	XVBC5B5	0.170	
		Blue	XVBC5B6	0.170	
		Clear	XVBC5B7	0.170	
		Yellow	XVBC5B8	0.170	
		~ 120 V	Green	XVBC5G3	0.170
			Red	XVBC5G4	0.170
Orange	XVBC5G5		0.170		
Blue	XVBC5G6		0.170		
Clear	XVBC5G7		0.170		
Yellow	XVBC5G8		0.170		
~ 230 V	Green		XVBC5M3	0.170	
	Red		XVBC5M4	0.170	
	Orange	XVBC5M5	0.170		
	Blue	XVBC5M6	0.170		
	Clear	XVBC5M7	0.170		
	Yellow	XVBC5M8	0.170		

Protected LED

(1) To order an illuminated unit with integral LED pre-fitted with light diffuser XVZ18, add the letter "D" to the end of the reference. Example: XVBC2B3D.

## Signaling Units

Modular tower lights

Harmony® type XVBC Ø 70

Tower lights for customer assembly (up to 5 units)

Illuminated units with integral “flash” discharge tube

For use with base unit XVBC●●: see page 14

821006



XVBC6●●

821006



XVBC8●●

### Illuminated units with 5 Joule “flash” discharge tube (1)

Description	Light source	Color	Reference	Weight kg	
Illuminated units	Integral “flash” discharge tube ≈ 24 V	Green	<b>XVBC6B3</b>	0.295	
		Red	<b>XVBC6B4</b>	0.295	
		Orange	<b>XVBC6B5</b>	0.295	
		Blue	<b>XVBC6B6</b>	0.295	
		Clear	<b>XVBC6B7</b>	0.295	
		Yellow	<b>XVBC6B8</b>	0.295	
		Integral “flash” discharge tube ~ 120 V	Green	<b>XVBC6G3</b>	0.280
			Red	<b>XVBC6G4</b>	0.280
	Orange		<b>XVBC6G5</b>	0.280	
	Blue		<b>XVBC6G6</b>	0.280	
	Clear		<b>XVBC6G7</b>	0.280	
	Yellow		<b>XVBC6G8</b>	0.280	
	Integral “flash” discharge tube ~ 230 V	Green	<b>XVBC6M3</b>	0.290	
		Red	<b>XVBC6M4</b>	0.290	
		Orange	<b>XVBC6M5</b>	0.290	
		Blue	<b>XVBC6M6</b>	0.290	
		Clear	<b>XVBC6M7</b>	0.290	
		Yellow	<b>XVBC6M8</b>	0.290	

### Illuminated units with 10 Joule “flash” discharge tube (1)

Description	Light source	Color	Reference	Weight kg	
Illuminated units	Integral “flash” discharge tube ≈ 24 V	Green	<b>XVBC8B3</b>	0.305	
		Red	<b>XVBC8B4</b>	0.305	
		Orange	<b>XVBC8B5</b>	0.305	
		Blue	<b>XVBC8B6</b>	0.305	
		Clear	<b>XVBC8B7</b>	0.305	
		Yellow	<b>XVBC8B8</b>	0.305	
		Integral “flash” discharge tube ≈ 48 V	Orange	<b>XVBC8E5</b>	0.315
	Integral “flash” discharge tube ~ 120 V	Green	<b>XVBC8G3</b>	0.315	
		Red	<b>XVBC8G4</b>	0.315	
		Orange	<b>XVBC8G5</b>	0.315	
		Blue	<b>XVBC8G6</b>	0.315	
		Clear	<b>XVBC8G7</b>	0.315	
		Yellow	<b>XVBC8G8</b>	0.315	
	Integral “flash” discharge tube ~ 230 V	Green	<b>XVBC8M3</b>	0.315	
		Red	<b>XVBC8M4</b>	0.315	
		Orange	<b>XVBC8M5</b>	0.315	
		Blue	<b>XVBC8M6</b>	0.315	
		Clear	<b>XVBC8M7</b>	0.315	
		Yellow	<b>XVBC8M8</b>	0.315	

(1) **Warning:** illuminated units with a “flash” discharge tube are not suitable for steady light signaling due to the heat generated.

# Signaling Units

## Modular tower lights

### Harmony® type XVBC Ø 70

Tower lights for customer assembly (up to 5 units)

Audible units, base units, cover, accessories



XVBC9



XVBC07



XVBC081

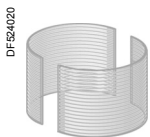

XVBZ18

Audible units			
Description	Characteristics	Reference	Weight kg
<b>Buzzer, 90 dB at 1 m</b> Adjustable with microswitch: - from 70 to 90 dB - continuous or intermittent tone	≈ 12...48 V	<b>XVBC9B</b>	0.170
	≈ 120...230 V	<b>XVBC9M</b>	0.180

Base units - for direct (IP 66) or tube fixing				
Description	For use with	Type	Reference	Weight kg
<b>Base unit + cover</b> with bottom or side cable entry	Modular tower lights without "flash" discharge tube unit	Standard	<b>XVBC21</b>	0.190
<b>Base unit only</b> with bottom or side cable entry	Modular tower lights with "flash" discharge tube unit	Standard	<b>XVBC07</b>	0.160
<b>Base unit + cover</b> with side cable entry	All types of modular tower lights	AS-Interface (1)	<b>XVBC21A</b>	-
<b>Base unit + cover</b> with bottom entry, pre-cabled (length 1 m) and fitted with M12 end connector	All types of modular tower lights	AS-Interface (1)	<b>XVBC21B</b>	-

Accessories specific to tower lights XVBC			
Description	Application	Unit reference	Weight kg
<b>Cover only</b>	For use with XVBC2, XVBC3, XVBC4, XVBC5 and XVBC9	<b>XVBC081</b>	0.030
<b>Set of 6 colored markers</b>	For identification of the position of units in the event of dismantling the modular tower light	<b>XVBC22</b>	0.001
<b>Set of 5 legend holders</b>	For identification of stacked units on base unit	<b>XVBC23</b>	0.002
<b>Sheet of 85 legends</b>	For use with base unit legend holder XVBC23	<b>XVBCY1</b>	0.005
<b>Sheet of 52 legends</b>	For identification of stacked units, used on locking ring	<b>XVBCY2</b>	0.005
<b>Adaptor for side entry through base unit</b>	With 13P cable gland	<b>XVBC14</b>	0.015
<b>SIS labelling software</b> (in English, French, German, Italian and Spanish)	For creating legends	<b>XBY2U</b>	0.100
<b>Light diffuser, clear plastic</b> (Sold in boxes)	Only for use with LED illuminated units (all colors) One box allows to equip 5 illuminated units.	<b>XVBZ18</b>	0.080

(1) For further information on AS-Interface connections, refer to our "Industrial communication in machines and installations" catalog.

# Signaling Units

Modular tower lights

Harmony® type XVB Ø 70

Illuminated beacons, tower lights for customer assembly (up to 5 units)

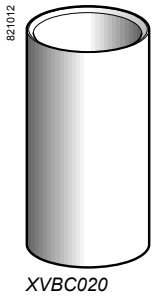

DL1BD●●/DL1BK●●

### Accessories common to beacons XVB and tower lights XVC

Description	Height under base unit (mm)	Color	Reference	Weight kg
Fixing bases comprising Ø 25 mm aluminium support tube glued into a black plastic fixing plate (IP 65)	80	Black aluminium	XVBZ02	0.110
	380	Aluminium	XVBZ02A	0.110
		Black aluminium	XVBZ03	0.200
	780	Aluminium	XVBZ03A	0.200
		Black aluminium	XVBZ04	0.325
	Aluminium	XVBZ04A	0.325	

Description	For use with	Material	Reference	Weight kg
Support tube concealment cover	Support tubes XVBZ02, XVBZ02A	ABS	XVC020	0.080
	Support tubes XVBZ03, XVBZ03A	ABS	XVC030	0.305
	Support tubes XVBZ04, XVBZ04A	ABS	XVC040	0.610
Ø 25 mm aluminium support tube	Fixing plate XVBZ01 (to be glued into the plastic fixing plate)	Plastic	XVBZ14	0.690
Fixing plate for use on horizontal support	Ø 25 mm aluminium support tube	Plastic	XVBZ01	0.050
Fixing plate for use on vertical support	Base unit (direct mounting), fixing plate XVBZ01 or fixing bases XVBZ0●	Zamak	XVC12	0.380

Description	Characteristics	Sold in lots of	Unit reference	Weight kg	
Incandescent bulbs (1) BA 15d base fitting	12 V	7 W	10	DL1BEJ	0.090
	24 V	6.5 W	10	DL1BEB	0.090
	48 V	6 W	10	DL1BEE	0.090
	120 V	7 W	10	DL1BEG	0.090
	230 V	7 W	10	DL1BEM	0.090

LEDs (1) BA 15d base fitting	~ 24 V	Color	Quantity	Unit reference	Weight kg	
Protected LED	~ 24 V	White	1	DL1BDB1	0.015	
		Green	1	DL1BDB3	0.015	
		Red	1	DL1BDB4	0.015	
		Orange	1	DL1BDB5	0.015	
		Blue	1	DL1BDB6	0.015	
		Yellow	1	DL1BDB8	0.015	
		~ 120 V	White	1	DL1BDG1	0.015
			Green	1	DL1BDG3	0.015
	Red		1	DL1BDG4	0.015	
	Orange		1	DL1BDG5	0.015	
	Blue		1	DL1BDG6	0.015	
	Yellow		1	DL1BDG8	0.015	
	~ 230 V		White	1	DL1BDM1	0.015
			Green	1	DL1BDM3	0.015
		Red	1	DL1BDM4	0.015	
		Orange	1	DL1BDM5	0.015	
Blue		1	DL1BDM6	0.015		
Yellow		1	DL1BDM8	0.015		

Flashing LEDs (1) BA 15d base fitting	~ 24 V	Color	Quantity	Unit reference	Weight kg	
Protected LED	~ 24 V	White	1	DL1BKB1	0.015	
		Green	1	DL1BKB3	0.015	
		Red	1	DL1BKB4	0.015	
		Orange	1	DL1BKB5	0.015	
		Blue	1	DL1BKB6	0.015	
		Yellow	1	DL1BKB8	0.015	
		~ 120 V	White	1	DL1BKG1	0.015
			Green	1	DL1BKG3	0.015
	Red		1	DL1BKG4	0.015	
	Orange		1	DL1BKG5	0.015	
	Blue		1	DL1BKG6	0.015	
	Yellow		1	DL1BKG8	0.015	
	~ 230 V		White	1	DL1BKM1	0.015
			Green	1	DL1BKM3	0.015
		Red	1	DL1BKM4	0.015	
		Orange	1	DL1BKM5	0.015	
		Blue	1	DL1BKM6	0.015	
		Yellow	1	DL1BKM8	0.015	

(1) Warning: illuminated units with incandescent bulbs must not be combined with LED illuminated units, due to the risk of overheating. Also, when different units (e.g. steady, flashing...) are combined, the maximum temperature is limited to that of the weaker unit.

# Search, visualize, and download

Use your tablet or your PC to quickly access detailed and comprehensive information on our products



## Tablets

Application name: "Automation Library by Schneider Electric"

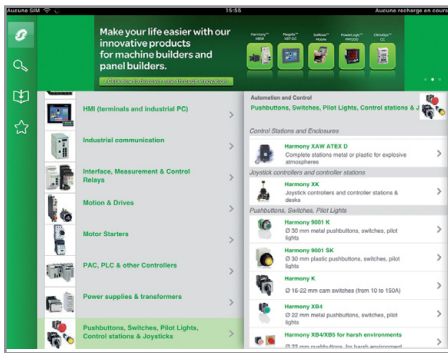

Product ranges displayed by function

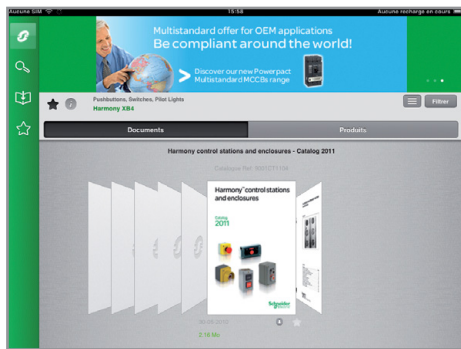

Dynamic catalogs (hyperlinks, video, ...)

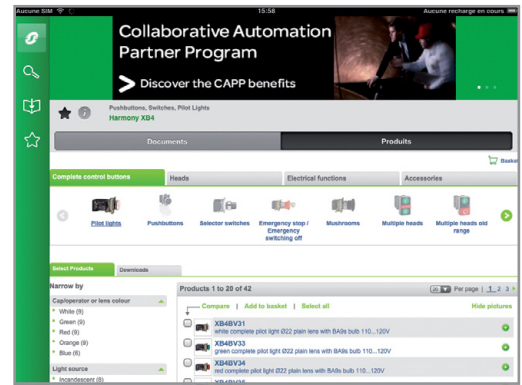

Product selector: dynamic filters to get easily your part number





# Personal computer

Path: [www.schneider-electric.com](http://www.schneider-electric.com) > **Products and Services** > Automation and control > Product offer

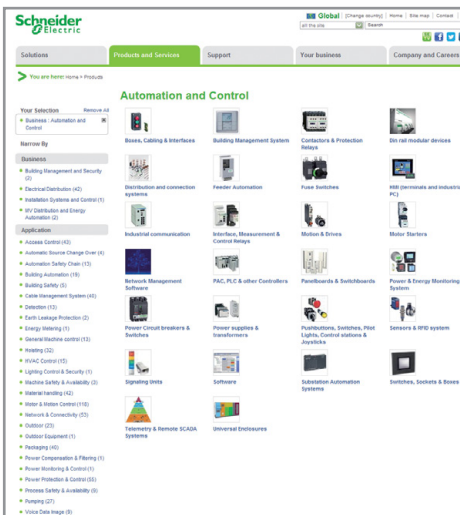

**Product ranges displayed by function**

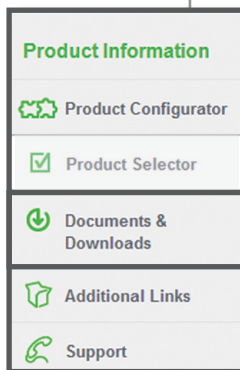
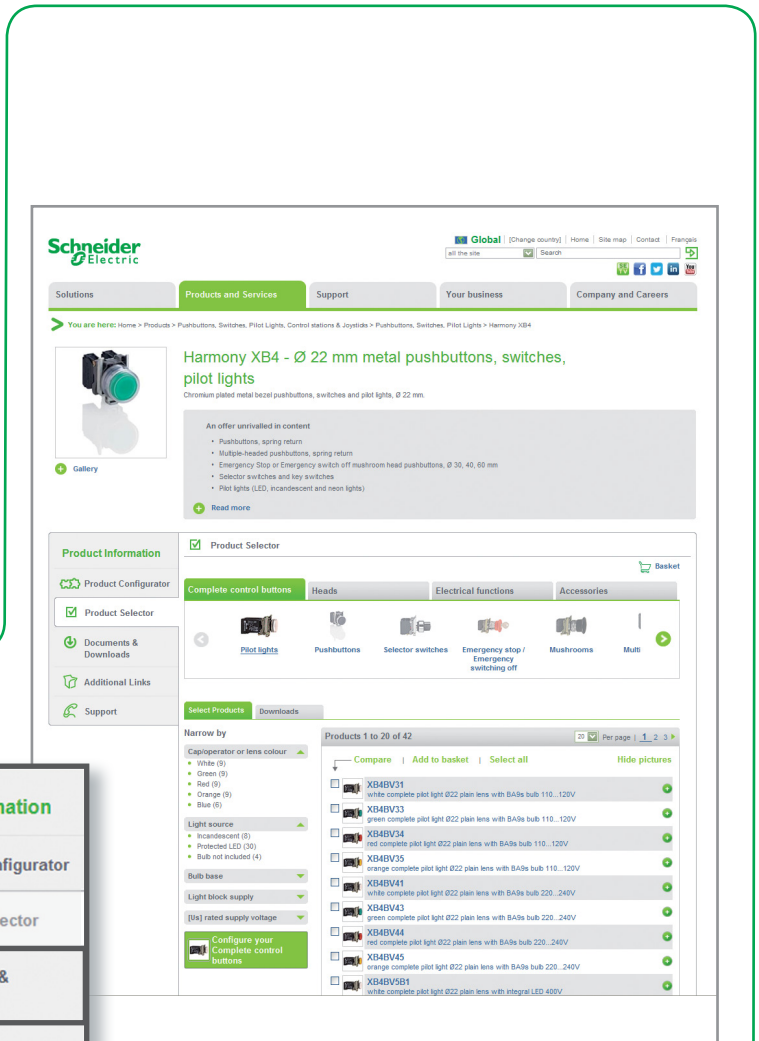

**Dynamic catalogs** (hyperlinks, video, ...)

**Product selector: dynamic filters** to get easily your part number

# Access product references with adapted tools



Path: [www.schneider-electric.com](http://www.schneider-electric.com) > **Products and Services** > Automation and control > ... > Product offer

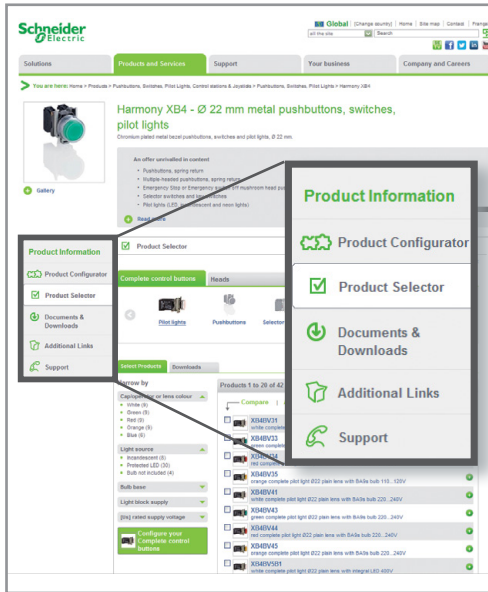

**Graphic product configurator**  
Select the right product with just a few clicks

**Dynamic product selector**  
Visualize product characteristics and dimensions

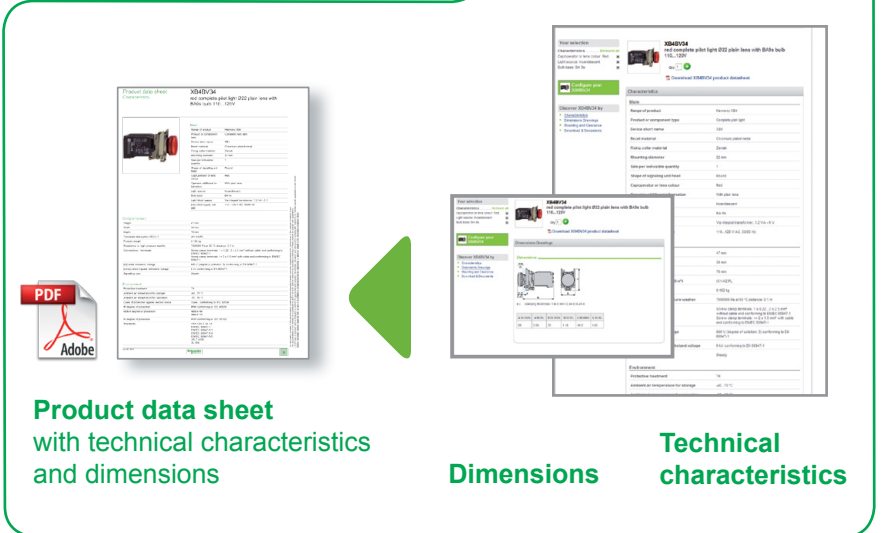



# Compare, select, and compile



Path: [www.schneider-electric.com](http://www.schneider-electric.com) > **Products and Services** > Automation and control > ... > Harmony XB4\*

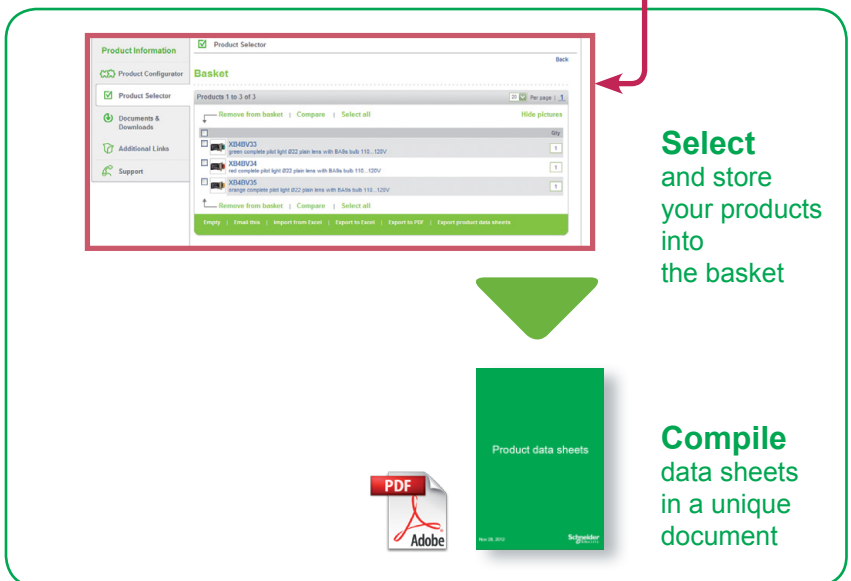
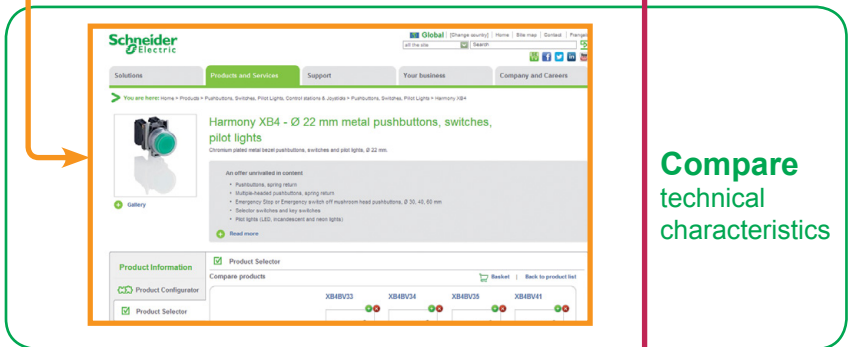
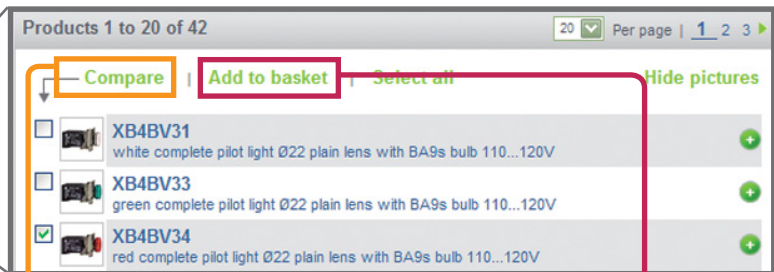

\* Example of research on a product

# Check the product status, design your equipment



Path: [www.schneider-electric.com](http://www.schneider-electric.com) > **Support** > Product Substitution Tool  
 Path: [www.schneider-electric.com](http://www.schneider-electric.com) > **Support** > CAD files

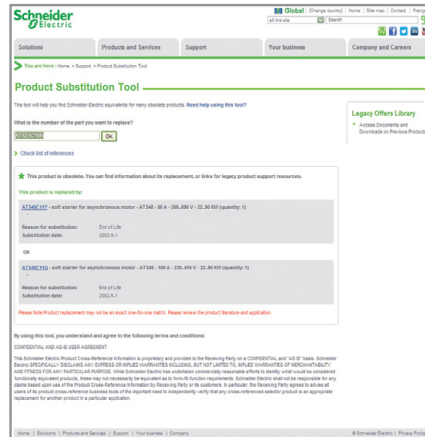
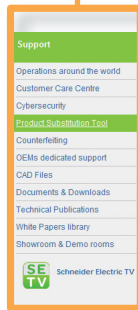
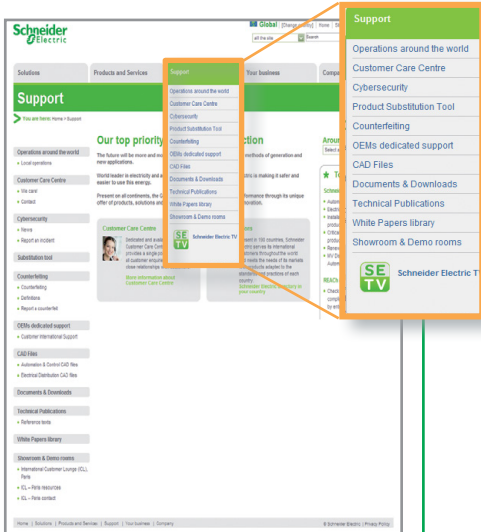

**Product status:**  
 indicate whether the product is still commercialized. Otherwise, the tool suggests a product substitution.

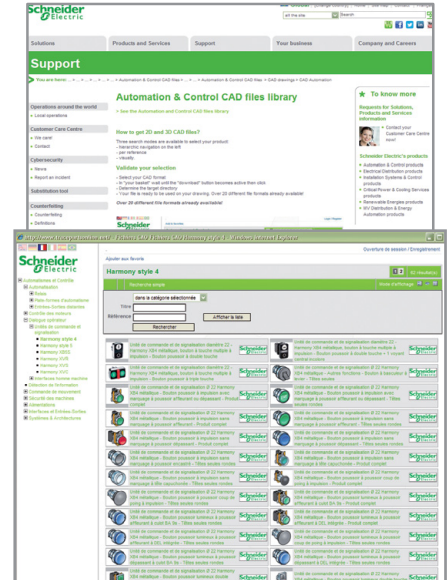

**CAD files:**  
 available in various formats they will be easily integrated into your installation design software.

Please note that references to products and services are just examples.

D									
DL1BDB1	15	XVBC2B6	12	XVBC6G4	13	XVBL0B7	9	XVBL6G4	10
DL1BDB3	15	XVBC2B7	12	XVBC6G5	13	XVBL0B8	9	XVBL6G5	10
DL1BDB4	15	XVBC2B8	12	XVBC6G6	13	XVBL0G3	9	XVBL6G6	10
DL1BDB5	15	XVBC2G3	12	XVBC6G7	13	XVBL0G4	9	XVBL6G7	10
DL1BDB6	15	XVBC2G4	12	XVBC6G8	13	XVBL0G5	9	XVBL6G8	10
DL1BDB8	15	XVBC2G5	12	XVBC6M3	13	XVBL0G6	9	XVBL6M3	10
DL1BDG1	15	XVBC2G6	12	XVBC6M4	13	XVBL0G7	9	XVBL6M4	10
DL1BDG3	15	XVBC2G7	12	XVBC6M5	13	XVBL0G8	9	XVBL6M5	10
DL1BDG4	15	XVBC2G8	12	XVBC6M6	13	XVBL0M3	9	XVBL6M6	10
DL1BDG5	15	XVBC2M3	12	XVBC6M7	13	XVBL0M4	9	XVBL6M7	10
DL1BDG6	15	XVBC2M4	12	XVBC6M8	13	XVBL0M5	9	XVBL6M8	10
DL1BDG8	15	XVBC2M5	12	XVBC07	14	XVBL0M6	9	XVBL8B3	10
DL1BDM1	15	XVBC2M6	12	XVBC8B3	13	XVBL0M7	9	XVBL8B4	10
DL1BDM3	15	XVBC2M7	12	XVBC8B4	13	XVBL0M8	9	XVBL8B5	10
DL1BDM4	15	XVBC2M8	12	XVBC8B5	13	XVBL1B3	9	XVBL8B6	10
DL1BDM5	15	XVBC4B3	11	XVBC8B6	13	XVBL1B4	9	XVBL8B7	10
DL1BDM6	15	XVBC4B4	11	XVBC8B7	13	XVBL1B5	9	XVBL8B8	10
DL1BDM8	15	XVBC4B5	11	XVBC8B8	13	XVBL1B6	9	XVBL8G3	10
DL1BEB	15	XVBC4B6	11	XVBC8E5	13	XVBL1B7	9	XVBL8G4	10
DL1BEE	15	XVBC4B7	11	XVBC8G3	13	XVBL1B8	9	XVBL8G5	10
DL1BEG	15	XVBC4B8	11	XVBC8G4	13	XVBL1G3	9	XVBL8G6	10
DL1BEJ	15	XVBC4M3	11	XVBC8G5	13	XVBL1G4	9	XVBL8G7	10
DL1BEM	15	XVBC4M4	11	XVBC8G6	13	XVBL1G5	9	XVBL8G8	10
DL1BKB1	15	XVBC4M5	11	XVBC8G7	13	XVBL1G6	9	XVBL8M3	10
DL1BKB3	15	XVBC4M6	11	XVBC8G8	13	XVBL1G7	9	XVBL8M4	10
DL1BKB4	15	XVBC4M7	11	XVBC8M3	13	XVBL1G8	9	XVBL8M5	10
DL1BKB5	15	XVBC4M8	11	XVBC8M4	13	XVBL1M3	9	XVBL8M6	10
DL1BKB6	15	XVBC5B3	12	XVBC8M5	13	XVBL1M4	9	XVBL8M7	10
DL1BKB8	15	XVBC5B4	12	XVBC8M6	13	XVBL1M5	9	XVBL8M8	10
DL1BKG1	15	XVBC5B5	12	XVBC8M7	13	XVBL1M6	9	XVBL33	8
DL1BKG3	15	XVBC5B6	12	XVBC8M8	13	XVBL1M7	9	XVBL34	8
DL1BKG4	15	XVBC5B7	12	XVBC9B	14	XVBL1M8	9	XVBL35	8
DL1BKG5	15	XVBC5B8	12	XVBC9M	14	XVBL4B3	8	XVBL36	8
DL1BKG6	15	XVBC5G3	12	XVBC14	14	XVBL4B4	8	XVBL37	8
DL1BKG8	15	XVBC5G4	12	XVBC21	14	XVBL4B5	8	XVBL38	8
DL1BKM1	15	XVBC5G5	12	XVBC21A	14	XVBL4B6	8	XVBZ01	15
DL1BKM3	15	XVBC5G6	12	XVBC21B	14	XVBL4B7	8		
DL1BKM4	15	XVBC5G7	12	XVBC22	14	XVBL4B8	8		
DL1BKM5	15	XVBC5G8	12	XVBC23	14	XVBL4M3	8		
DL1BKM6	15	XVBC5M3	12	XVBC33	11	XVBL4M4	8		
DL1BKM8	15	XVBC5M4	12	XVBC34	11	XVBL4M5	8		
		XVBC5M5	12	XVBC35	11	XVBL4M6	8		
		XVBC5M6	12	XVBC36	11	XVBL4M7	8		
		XVBC5M7	12	XVBC37	11	XVBL4M8	8		
		XVBC5M8	12	XVBC38	11	XVBL6B3	10		
XBY2U	14	XVBC6B3	13	XVBC081	14	XVBL6B4	10		
XVBC020	15	XVBC6B4	13	XVBCY1	14	XVBL6B5	10		
XVBC030	15	XVBC6B5	13	XVBCY2	14	XVBL6B6	10		
XVBC040	15	XVBC6B6	13	XVBL0B3	9	XVBL6B7	10		
XVBC2B3	12	XVBC6B7	13	XVBL0B4	9	XVBL6B8	10		
XVBC2B4	12	XVBC6B8	13	XVBL0B5	9	XVBL6G3	10		
XVBC2B5	12	XVBC6G3	13	XVBL0B6	9				



**Schneider Electric Industries SAS**

[www.schneider-electric.com](http://www.schneider-electric.com)

Head Office  
35, rue Joseph Monier  
F-92500 Rueil-Malmaison  
France

The information provided in this documentation contains general descriptions and/or technical characteristics of the performance of the products contained herein. This documentation is not intended as a substitute for and is not to be used for determining suitability or reliability of these products for specific user applications. It is the duty of any such user or integrator to perform the appropriate and complete risk analysis, evaluation and testing of the products with respect to the relevant specific application or use thereof. Neither Schneider Electric nor any of its affiliates or subsidiaries shall be responsible or liable for misuse of the information contained herein.

Design: Schneider Electric  
Photos: Schneider Electric  
Printed by:

DIA5ED2130801EN

September 2013