

# Product End-of-Life Instructions

## XU photoelectric sensors

### Product Range

XU parallelepipedic photoelectric sensors

### Marketing Model

XUK, XULM and XUM Photoelectric Sensors & XUZ Photoelectric Sensors Accessories

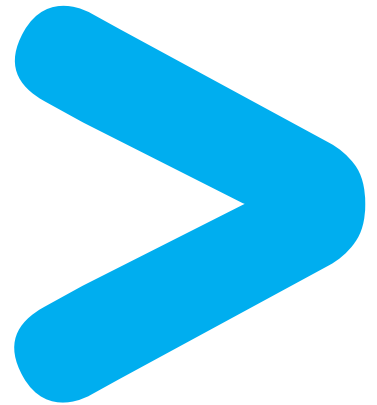
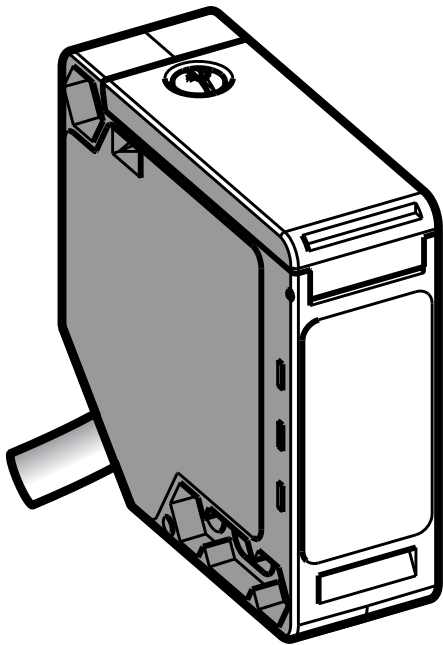

### Size in mm:

H x L x D : 50 x 50 x 20 for the body of XUK0ARCTL2

### Weight in g:

150 for XUK0ARCTL2



Telemecanique

Sensors

## Operations recommended for the end of life treatment

There are several steps to process the products at the end of life so as to recover components, materials or energy:

**Reuse** ⇒ **Separation for special treatment** ⇒ **Other dismantling** ⇒ **Shredding**

The components of the products that are recommended to be separated from the flow of waste for special treatment are listed, identified and located hereunder.

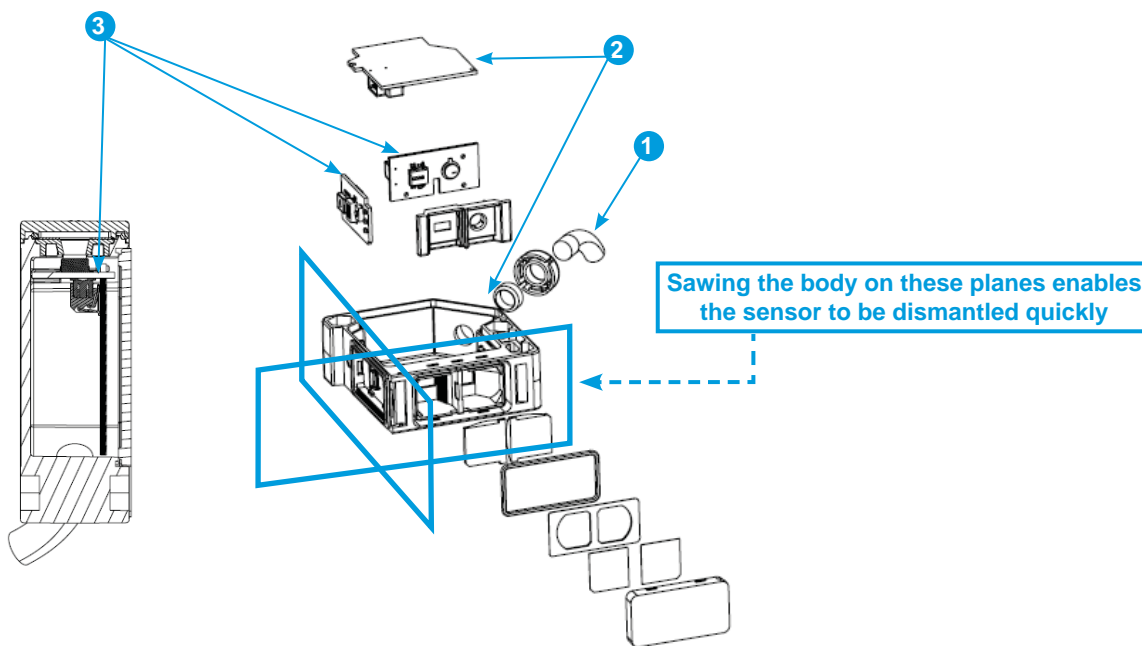

Comment	Number on drawing	Components	Weight	Comment
Special treatment	①	External electrical cable	50 g/m	To be cut and sent for special treatment
Special treatment	②	Plastic enclosure	25 g for XUK0ARCTL2	To be dismantled and sent for special treatment
Special treatment	③	Electronic circuits	16 g for XUK0ARCTL2	To be cut and sent for special treatment

For more information please contact us at: [global-green-sensors@schneider-electric.com](mailto:global-green-sensors@schneider-electric.com).

### Schneider Electric Industries SAS

35, rue Joseph Monier  
CS30323  
F - 92506 Rueil Malmaison Cedex

RCS Nanterre 954 503 439  
Capital social 896 313 776 €  
[www.schneider-electric.com](http://www.schneider-electric.com)

The version of the Guide used to create the document: End of Life Instruction Drafting Guide of Schneider Electric version V3.

Publication : Schneider Electric